



K N I V E S

CATALOG 2013





Kai USA, Ltd., founded as Kershaw Knives in 1974, began with one mission: to design and manufacture tools that knife users would be proud to own, carry, and use. Today, premium materials, state-of-the-art manufacturing, extremely tight tolerances, and meticulous craftsmanship ensure that each Kershaw knife or tool provides a lifetime of performance and pride of ownership. The Kershaw brand is especially known for innovative technologies and materials, resulting in numerous industry awards. We manufacture most of our products in our 55,000 sq. ft. facility located south of Portland Oregon, in the city of Tualatin. Our campus houses a state-of-the-art manufacturing facility, our design, engineering, and manufacturing teams, as well as the customer service experts who sell and support our Kershaw brand knives and tools. Every Kershaw product is backed with a Limited Lifetime Warranty.

Please visit our new website at kershawknives.com

TABLE OF CONTENTS

NEW DESIGNS

- 5 Injection 3.5 3830
- 5 Injection 3.0 3820
- 5 Scrambler 3890
- 6 Thermite 3880
- 6 Cryo II 1556TI
- 6 Shuffle 8700
- 7 FreeFall 3840
- 7 Swerve 3850
- 7 Dimension 3810
- 8 Scallion (Navy Blue) 1620NB
- 8 Scallion (Purple) 1620PUR
- 8 Scallion (Olive Drab) 1620OL
- 9 Blur 1670RDBLKST
- 9 TaskMaster Saw 2555
- 9 Leek (Stonewashed, Black) 1660SWBLK
- 10 Leek (Purple) 1660PUR
- 10 Leek (Orange) 1660OR
- 10 Leek (Olive Drab) 1660OL
- 11 LoneRock Folder 1898
- 11 LoneRock Folder, Gut Hook 1898GH
- 12 LoneRock Lg Fixed, Gut Hook 1896GH
- 12 LoneRock Sm Fixed 1895
- 12 LoneRock ZipIt Pro 1894
- 13 Camp 10 1077
- 13 Camp 14 1076
- 13 Camp 18 1074
- 14 Spear-Point Bait Knife 1290
- 14 5-1/2 IN. Boning Knife 1291
- 14 5-1/2 IN. Gutting/Scaling Knife 1292

MANUAL

- 16 Skyline 1760
- 16 Junkyard Dog II 1725CB
- 16 OD-2 1770
- 17 Half-Ton 1445
- 17 3/4-Ton 1446
- 17 One-Ton 1447
- 18 Kurai 3700
- 18 Chill 3410
- 18 Select Fire 1920
- 19 Black Horse II 1060
- 19 Black Colt II 1045
- 19 Crown 3160
- 20 D.W.O 3000
- 20 D.W.O (Red) 3000RD
- 20 Silver Spur I 2800
- 20 Silver Spur II 2825
- 20 Wildcat Ridge 3140
- 20 Black Gulch 3120

- 20 Corral Creek 3115
- 20 Corral Creek Sheepsfoot 3115BT
- 20 Grant County 3100

SPEEDSAFE

- 22 Echelon 1880
- 22 Knockout 1870
- 22 Rake 1780CB
- 23 Piston 1860
- 23 Blur (Black) 1670BLK/ST
- 23 Blur (Olive Drab) 1670OL
- 23 Blur (Desert Sand) 1670DS
- 24 S30V Blur 1670S30V
- 24 Tanto Blur 1670TBLKST
- 24 Blur GlassBreaker 1670GGBLKST
- 25 Blackout 1550/ST
- 25 Whirlwind 1560/ST
- 25 Scallion 1620/ST
- 26 Scallion (Red) 1620RD
- 26 Scallion FL 1620FL/ST
- 26 Rainbow Scallion 1620VIB
- 27 Chive 1600
- 27 Chive (Black) 1600BLK
- 27 Chive (Pink) 1600PINK
- 28 Rainbow Chive 1600VIB
- 28 Shallot 1840/ST
- 28 Black Shallot 1840CKT/ST
- 28 Zing SS 1730SS
- 29 Leek 1660/ST
- 29 Rainbow Leek 1660VIB
- 29 Leek (Black) 1660CKT/ST
- 30 Random Leek 1660GRYST
- 30 Composite Blade Leek 1660CB
- 30 Needs Work 1820
- 31 Kuro 1835BLKST
- 31 Oso Sweet 1830
- 31 Cryo 1555TI
- 32 Burst 1970/ST
- 32 RJ I 1985ST
- 32 RJ II 1980ST
- 33 Volt II 3650/ST
- 33 Black Volt II 3650CKTST
- 33 Volt SS 3655
- 34 Brawler 1990
- 34 Clash 1605/ST
- 34 Black Clash 1605CKTST
- 35 Funxion Outdoor 8000OL
- 35 Funxion DIY 8200RD
- 35 Funxion EMT 8100GRYST

OUTDOORS

- 37 Mini Skinner 1081
- 37 Skinning Knife 1080
- 37 Skinning Knife (Orange) 1080OR
- 37 Field Knife 1082
- 37 Field Knife (Orange) 1082OR
- 38 Diskin Hunter 1085
- 38 Bear Hunter II 1029
- 38 Antelope Hunter II 1028
- 38 Antelope Hunter II (Orange) 1028OR
- 39 Roughneck 1010
- 39 Camo Scallion 1620C
- 39 Camo Black Horse II 1060RT
- 40 Folding Field 1050
- 40 Zipit 2520
- 40 Zipit (Orange) 2520OR
- 40 Taskmaster Shears 1120
- 41 Skeeter I 1210
- 41 Skeeter II 1215
- 41 7-1/2 IN. Fillet 1257
- 41 9 IN. Fillet 1259
- 41 Folding Fillet 1256
- 42 Pro Grade Series
- 43 Alaskan Blade Trader 1098AK
- 43 Hunter's Blade Trader 1094HBT
- 43 Sportsman's Blade Trader 1095SBT
- 44 Fisherman's Blade Trader 1096FBT
- 44 Camp-Tool Blade Trader 1091CT
- 44 Deluxe Blade Trader 1099DBT
- 45 Camp Ax 1018
- 45 Military Knife 4351
- 45 Ripcord 3200
- 46 Amphibian 1006K
- 46 Sea Hunter 1008
- 46 Sea Hunter (Blunt-Tip) 1008BL-P

HOUSEWARES

- 48 Housewares Series
- 49 9900 Block Set 9900-7
- 49 Steak Knife Set 9922-7
- 49 Cutting Board Set CB-3

ACCESSORIES

- 51 Firestarter 1019
- 51 Ultra-Tek Sharpener 2535
- 51 KeyChain T-Tool T TOOL
- 52 Kershaw T-Shirts
- 52 Kershaw Hats
- 52 Knife Storage Bag Z997

WHAT DO THE KERSHAW ICONS MEAN?

Our feature icons make it easier to identify the specific features of each Kershaw knife at a glance. Here's a guide for decoding the icons on our packaging and in this catalog:

OPENING SYSTEM

SOME KNIVES MAY HAVE BOTH SPEEDSAFE AND FLIPPER ICONS



SPEEDSAFE

Assists you to open any SpeedSafe® knife quickly and easily with a manual push on the thumbstud or pull back on the flipper; built into many Kershaw best sellers.



MANUAL

There is no mechanical assist, such as SpeedSafe, used to open the folding knife. It opens the classic, old-school way.



FLIPPER

May be used on either manual or assisted opening knives. The "flipper" is a protrusion on the back of the blade used to open the knife.

GRIP TEXTURE



K-TEXTURE

K-Texture is an exclusive Kershaw handle texture that provides for an extremely secure grip.

SHEATH

INCLUDES SHEATH, BLADE GUARD, OR OTHER STORAGE SYSTEM



SHEATH

Comes with a storage and/or carrying sheath. These knives may be too large for pocket carry or are fixed-blade knives. Sheaths may be either leather or nylon.



BLADE GUARD

Kershaw blade guards are soft, molded plastic that fit over the entire blade to protect the edge during storage—and to protect the user from the sharp blade.

POCKETCLIPS



SINGLE POSITION

The pocketclip is in a fixed position on the knife handle; usually it is positioned for tip-down, right-handed carry, though this may vary.



REVERSIBLE

Pre-drilled holes in the handle enable the user to change either the tip position or the side on which the knife carries.



TRI-CARRY

The user may position the pocketclip for tip-up or tip-down carry on one side and one-position carry on the other.



QUAD-CARRY

The user may position the pocketclip for tip-up or tip-down, left- or right-handed carry.

SERRATIONS

WHEN YOU SEE THESE ICONS, THE KNIFE EITHER HAS SERRATIONS OR IS AVAILABLE WITH SERRATIONS.



**2-STEP
SERRATION**

Serrations assist in cutting through particularly tough or fibrous material, such as rope or cord. The Kershaw 2-step serration is a more aggressive style of serration.



**SCALLOP
SERRATION**

Serrations assist in cutting through particularly tough or fibrous material, such as rope or cord. The scalloped serration offers even cutting power on both push and pull strokes.

LOCK TYPE

BLADE LOCKS ARE A SAFETY FEATURE



**INSET LINER
LOCK**

A strip of stainless steel is riveted inside the knife's handle. This enables us to create a slimmer, lighter knife, while still providing the strength and security of a locking liner.



**SUB-FRAME
LOCK**

One side of a lightweight handle, or frame, is fitted with a steel plate integral to the frame; it is the part of the frame that moves behind the blade to lock it into position during use.



FRAME LOCK

A portion of the handle (the knife frame) moves behind the blade to lock it into position during use.



LINER LOCK

Locks the blade open during use; one side of the knife's steel "liner," the steel plate to which the handle scales are attached, moves into position behind the blade to securely lock it open.



LOCK BACK

A strip of steel on the back of the knife moves into place behind the blade to lock the knife safely and securely open during use.



PUSH BUTTON

Locks the blade open during use, then releases it with the push of a button for easy storage or carry.

BLADE TYPE



FIXED

The knife does not fold closed; usually stored in a sheath or blade protector.



MULTI-FUNCTION

Has multiple blades or tools, enabling it to perform multiple functions.



BLADE TRADER

Blade Traders are knives with interchangeable blades so you can carry more knives in less space.



**COMPOSITE
BLADE**

A blade composed of several types of steel brazed together in a permanent joint; the technology enables Kershaw to use steel known for edge holding on the edge, strength on the spine for the best of both worlds.

KERSHAW FAQs

IS A SPEEDSAFE® KNIFE AN AUTOMATIC KNIFE?

No. There are many unique features of SpeedSafe knives that make them quite different from knives that are considered switchblades or automatic knives. Unlike an automatic, SpeedSafe blades DO NOT deploy with the push of a button in the handle or by gravity alone. Instead, the user must overcome the torsion bar's resistance in order to engage the SpeedSafe system. Because of this, SpeedSafe knives fall fully outside the Federal definition of an automatic or switchblade knife. However, due to the complexity and constantly changing nature of these laws and regulations, it is impossible for Kershaw Knives to be aware of every restriction in every location in which our knives are sold or carried. It is the responsibility of the buyer to investigate and comply with the laws and regulations that apply in his or her specific area.

WHAT DOES THE "X" MEAN IN A KERSHAW MODEL NUMBER?

When you see an "X" after the model number of a Kershaw knife on your order—for example, 1660X—it means that the knife is in a clampack rather than a closed box. Our new clampack packaging uses much less plastic than previous clampacks, which our consumers will like, while still providing tamper-proof security. There is absolutely no difference in the knives themselves. The only difference is the type of packaging. Many Kershaw models are available in your choice of clampack or box; others are only available in one packaging style.

On the other hand, if you see "XXXX" marked on the blade of the knife, it means that the knife is a factory second and was probably purchased at our annual Warehouse Sale. Usually, these knives have only cosmetic defects with no difference in performance. It's just that they have not passed our rigorous inspection process and are not covered by our warranty.

WHY DO YOU "RESERVE THE RIGHT TO CHANGE SPECIFICATIONS?"

"We reserve the right to change specifications, materials, or country of origin at any time, without notice." You'll see this notice on Kershaw packaging, catalogs, and product literature. The reason we reserve this right is that from prototype to final production, there can be changes either in the final production design of the knife and/or in the availability of any given material at any given time. For example, if we run into supply issues with the steel we originally specified for a new knife, we may substitute another, comparable and more readily available steel. Nevertheless, the new material will always offer similar characteristics and performance to the original spec. Specifications might also change if we move the production location. For example, knives made with 14C28N blade steel in the US will be made with high-performance 8Cr13MoV in China. But no matter where they're made, all Kershaw knives must meet our high standards for quality, fit and finish, and function.

WHY DOES IT TAKE SO LONG TO GET THE KNIFE WHEN I'VE ALREADY SEEN THE PROTOTYPE?

A prototype is far from being a knife that's ready for production. To understand, you have to know something about the whole process...

A prototype is simply a full-scale working model of a knife Kershaw intends to bring to market. Usually, the proto is one-(or maybe two) of-a-kind. So, like a custom knife, the prototype is individually handmade by Kershaw engineers, machinists, and assemblers.

The next step is getting feedback on the prototype from our customers and our industry—so we take it to one of the industry trade shows. Based on the feedback we receive, we frequently make adjustments to the prototype. We may also make changes to the prototype in order to ensure manufacturing

is as efficient as possible. As you can imagine, this adds time to the production schedule.

From first prototype to product-in-your-hands, it usually takes about a year to the first production run. That's why it's important to stay in contact with your Kershaw representative and plan your orders carefully to ensure you always have the Kershaw knives you want on hand for your customers. Your Kershaw rep is always ready to help!

NEW FROM KERSHAW

For 2013, Kershaw is offering an exciting, new collection of knives from the Kershaw design team, as well as some awesome collaborations with custom knifemakers like Todd Rexford, Rick Hinderer, and RJ Martin. For hunters, we're introducing a line of great-looking hunting knives that provide a razor edge and an ultra-secure grip, thanks to our new K-Texture handle. K-Texture ensures a sturdy grip under just about any environmental condition, from wet and cold to hot and dry. In answer to customer requests, we've also made some new additions to existing lines—like our new jewel tone Leeks and Scallions. This year, look to Kershaw for new styles, new colors, new tech, and some of the coolest knives on the planet.



NEW DESIGNS



3830 INJECTION 3.5

STEEL 8CR13MOV, BEAD-BLASTED FINISH

HANDLE 3-D MACHINED G-10

BLADE 3-1/4 IN.

CLOSED 4-1/2 IN.

WEIGHT 4.4 OZ.



The new Injection 3.5 has the custom features and details knife fans crave—at a price they can afford. The classic drop-point blade offers a full-width grind and opens manually with a custom thumbstud countersunk into the blade. The G-10 handle scales are contoured and machined in a horizontal pattern for extra grip. Other premium details include steel liners that show through the handle scale cutouts, decorative pivot hardware, and reversible pocketclip. Designed by Todd Rexford.



3820 INJECTION 3.0

STEEL 8CR13MOV, BEAD-BLASTED FINISH

HANDLE 3-D MACHINED G-10

BLADE 3 IN.

CLOSED 4-1/8 IN.

WEIGHT 3.3 OZ.



This smaller version of the Injection offers all the custom details of the larger version, but with a 3-inch blade that works better in states with blade-length limits for carrying knives. Designed by Todd Rexford.



3890 SCRAMBLER

STEEL 8CR13MOV, TITANIUM CARBO-NITRIDE COATING

HANDLE TEXTURED G-10/STEEL BOLSTER FRONT, 410 STEEL BACK, TITANIUM CARBO-NITRIDE COATING

BLADE 3-1/2 IN.

CLOSED 4-3/8 IN.

WEIGHT 5.2 OZ.



The Scrambler's classy, drop-point blade is hollow-ground so it breezes through slicing tasks, while a flat-ground, large top swedge looks cool. The handle is G-10 with a steel bolster on one side; on the other, an all-steel frame lock. SpeedSafe-equipped, the knife opens quickly and easily and includes a reversible pocketclip. Designed by RJ Martin.

3880 THERMITE

STEEL 8CR13MOV, STONEWASHED FINISH

HANDLE TEXTURED G-10 FRONT, 410 STEEL BACK, STONEWASHED FINISH

BLADE 3-1/2 IN.

CLOSED 4-7/8 IN.

WEIGHT 4.5 OZ.



With tactical styling and practical performance, the Thermite has a great look and great features. The 3 1/2-in. stonewashed blade is hollow-ground for excellent slicing capabilities with a flat-ground "spanto" tip for strong piercing. It's SpeedSafe-equipped, has a frame lock with lockbar stabilizer, and even has Kershaw's Quad-Carry pocketclip. Designed by Rick Hinderer.

1556TI CRYO II

STEEL 8CR13MOV, TITANIUM CARBO-NITRIDE COATING

HANDLE 410, TITANIUM CARBO-NITRIDE COATING

BLADE 3-3/8 IN.

CLOSED 4-3/8 IN.

WEIGHT 5.5 OZ.



The new Kershaw Cryo II is significantly larger than the original Cryo. With its 3-1/4 in., SpeedSafe-equipped blade, this classic design was built for those who just demand more from a pocketknife. More size. More features. More style. Though it's a larger knife, the Cryo II is remarkably slim and rides comfortably deep in the pocket thanks to our deep-carry clip. Designed by Rick Hinderer.

8700 SHUFFLE

STEEL 8CR13MOV, BEAD-BLASTED FINISH

HANDLE GLASS-FILLED NYLON, K-TEXTURE GRIP

BLADE 2-3/8 IN.

CLOSED 3-1/2 IN.

WEIGHT 2.8 OZ.



This chubby-bladed knife is a multi-function tool. The Shuffle features a capable, wide drop-point blade, a backspacer that doubles as a bottle opener, and a lanyard hole that is also an emergency screwdriver. To make sure this tough little knife stays put in your hand, it has an oversized choil and a finger-contoured handle with the new Kershaw K-Texture grip.





3840 FREEFALL

STEEL 8CR13MOV, STONEWASHED FINISH

HANDLE GLASS-FILLED NYLON, K-TEXTURE GRIP

BLADE 3-1/4 IN.

CLOSED 4-1/4 IN.

WEIGHT 4.1 OZ.



A tactically styled blade and a palm-gripping, ergonomic handle make the FreeFall an easy choice for tough piercing tasks as well as for every day carry. The blade is a modified tanto with a hollow-ground and slightly curved belly for versatile cutting. The tanto tip is flat-ground for strength. The handle is contoured to fit the palm and features Kershaw's new K-Texture grip for an extra secure hold.



3850 SWERVE

STEEL 8CR13MOV, STONEWASHED FINISH

HANDLE GLASS-FILLED NYLON, K-TEXTURE GRIP

BLADE 3 IN.

CLOSED 4-1/4 IN.

WEIGHT 4.8 OZ.



You're going to like this one. It's designed to be a right-sized, tough every day carrying and work knife. The extra-wide, drop-point blade offers excellent slicing and will handle just about anything. For incredible grip, the Swerve features Kershaw's new K-Texture grip. It opens one-handed with SpeedSafe, and features a reversible, deep-carry clip.



3810 DIMENSION

STEEL 8CR13MOV, STONEWASHED FINISH

HANDLE TITANIUM, MACHINED TEXTURE

BLADE 3 IN.

CLOSED 4-1/4 IN.

WEIGHT 5.0 OZ.



Craving some titanium with your steel? Kershaw's new Dimension is the answer. The handle is titanium with a machined texture for solid gripability. Use the built-in flipper or thumbstud to open it quickly and easily with SpeedSafe assisted opening. Lockup security is provided by the easily accessible button lock, while a Tri-Carry, three-position deep-carry pocketclip completes the handsome package.

1620NB SCALLION

STEEL 420HC, BEAD-BLASTED FINISH
HANDLE 6061-T6 ANODIZED ALUMINUM
BLADE 2-3/8 IN.
CLOSED 3-1/2 IN.
WEIGHT 2.6 OZ.



Our best-selling line of Kershaw Scallions gets some colorful new additions for 2013. This one comes in “shop coat” blue, a darker navy blue. The Scallion’s anodized aluminum handles look great in this new color, resist scratching, and make this Scallion a lightweight EDC. Same recurved blade and SpeedSafe assisted opening as all Scallions. Tip-Lock for added safety.

See the entire Scallion family, pages 25-26



1620PUR SCALLION

STEEL 420HC, BEAD-BLASTED FINISH
HANDLE 6061-T6 ANODIZED ALUMINUM
BLADE 2-3/8 IN.
CLOSED 3-1/2 IN.
WEIGHT 2.6 OZ.



Is the Scallion the perfect pocketknife? With its medium size, SpeedSafe assisted opening system, and recurve blade style, it just may be. The Scallion has been one of Kershaw’s top sellers from the beginning. For 2013, we freshened up the Scallion assortment with some exciting new colors. This one is a deep jewel tone purple with scratch-resistant anodized aluminum handles. Tip-Lock for added safety.



1620OL SCALLION

STEEL 420HC, BEAD-BLASTED FINISH
HANDLE 6061-T6 ANODIZED ALUMINUM
BLADE 2-3/8 IN.
CLOSED 3-1/2 IN.
WEIGHT 2.6 OZ.



The Scallion’s razor-sharp recurve blade handles all your pocketknife tasks and its SpeedSafe assisted opening ensures fast and easy one-handed opening. For 2013, we’ve added some new colors—including this great-looking olive drab Scallion with scratch-resistant anodized aluminum handles. Tip-Lock for added safety.



See entire Blur family
pages 23-24



1670RDBLKST BLUR

STEEL SANDVIK 14C28N, DLC COATING

HANDLE 6061-T6 ANODIZED ALUMINUM, TRAC-TEC INSERTS

BLADE 3-3/8 IN.

CLOSED 4 1/2 IN.

WEIGHT 3.9 OZ.



You've asked for it, now it's here. The classic Kershaw red Blur but with a black, DLC-coated blade. It looks great—and, like all Blurs, performs great, too. Anodized aluminum handles with Trac-Tec inserts ensure a secure grip. The Sandvik 14C28N blade provides maximum cutting power; the slight blade recurve and partial serration make it a formidable multi-tasker.

2555 TASKMASTER SAW

STEEL HIGH-CARBON STEEL, POWDERCOAT

HANDLE GLASS-FILLED NYLON, RUBBER OVERMOLD

BLADE 7 IN.

CLOSED 9-1/4 IN.

WEIGHT 9.2 OZ.



Extremely handy, extremely powerful—and won't take up a lot of room in your gear. Great for camping or hunting trips, and perfect for around-the-yard pruning, too. Also features a push-button locking mechanism.

1660SWBLK LEEK

STEEL SANDVIK 14C28N, STONWASHED FINISH

HANDLE 6061-T6 ANODIZED ALUMINUM

BLADE 3 IN.

CLOSED 4 IN.

WEIGHT 2.4 OZ.



New handle colors and blade finishes give the ever-popular Kershaw Leek a fresh, new look. Same high-performance 14C28N stainless steel blade, with a variety of great-looking handle choices. This Leek features a stonewashed blade.

1660PUR LEEK

STEEL SANDVIK 14C28N, BEADBLASTED FINISH

HANDLE 6061-T6 ANODIZED ALUMINUM

BLADE 3 IN.

CLOSED 4 IN.

WEIGHT 2.4 OZ.



The ever-popular Kershaw Leek is back for 2013 in a selection of fresh, new colors. This one shines in a rich, jewel tone purple. A Leek in this great color is destined to become a knife fan favorite. Like all Leeks, this one features SpeedSafe assisted opening and a useful drop-point blade. The pocketclip is reversible and a Tip-Lock enhances safety for secure pocket carry.

See entire Leek family
pages 29-30



1660OR LEEK

STEEL SANDVIK 14C28N, BEADBLASTED FINISH

HANDLE 6061-T6 ANODIZED ALUMINUM

BLADE 3 IN.

CLOSED 4 IN.

WEIGHT 2.4 OZ.



Scratch-resistant anodized aluminum handles in deep orange make this Kershaw Leek for 2013 stand out from the crowd. Like all Leeks, this new orange Leek offers SpeedSafe assisted opening and a slim, drop-point blade. The pocketclip is reversible and a Tip-Lock enhances safety for secure pocket carry.



1660OL LEEK

STEEL SANDVIK 14C28N, BEAD-BLASTED FINISH

HANDLE 6061-T6 ANODIZED ALUMINUM

BLADE 3 IN.

CLOSED 4 IN.

WEIGHT 2.4 OZ.



Also new for 2013 is Kershaw's olive drab Leek. It looks at home in the outdoors or as a handsome every day carrying knife. The olive drab Leek is equipped with SpeedSafe assisted opening for fast and easy one-handed opening. The pocketclip is reversible and a Tip-Lock enhances safety for secure pocket carry.



LONEROCK HUNTING SERIES

Kershaw is proud to introduce a new line of hunting knives—the LoneRock Series. These are state-of-the-art hunting knives, designed to provide the user with extremely tough and versatile tools that can stand up to just about anything. The entire series has been specially contoured and shaped to provide multiple grip options. So whether you need to choke up on the blade or grip the full handle for better leverage, these knives are always functional and easy to use.

K-TEXTURE® HANDLES

And speaking of grip, the LoneRock Series features Kershaw's exclusive K-Texture handles. The LoneRock series features rubberized K-Texture grip material that ensures a secure grip, even in extreme conditions. K-Texture provides additional "tooth" for even more enhanced grip strength. For the most secure grip on your tools, look for products with Kershaw's new K-Texture grip.



1898 LONEROCK FOLDER

STEEL 8CR13MOV, TITANIUM CARBO-NITRIDE COATING

HANDLE GLASS-FILLED NYLON, K-TEXTURE GRIP

BLADE 3-1/2 IN.

CLOSED 4-3/4 IN.



This new Kershaw hunting knife offers multiple grip options and Kershaw's K-Texture on the handle for a knife that's designed to work with you. An oversized choil and thumb grooves on each side of the handle enable you to choke up on the blade when necessary. Mid-spine jimping provides a good grip for fine control. A big belly makes skinning easier. This folder opens manually using the large groove in the blade—so there's no thumbstud to get in the way of your work. A sturdy mid-lock secures the blade.

1898GH LONEROCK FOLDER, GUT HOOK

STEEL 8CR13MOV, TITANIUM CARBO-NITRIDE COATING

HANDLE GLASS-FILLED NYLON, K-TEXTURE GRIP

BLADE 3-1/2 IN.

CLOSED 4-3/4 IN.



This new Kershaw hunting knife offers multiple grip options and Kershaw's K-Texture on the handle. An oversized choil and thumb grooves on either side of the handle enable you to choke up on the blade when necessary. Mid-spine jimping provides a good grip for fine control. A big belly and precise gut hook make skinning easier. This folder opens manually using the large groove in the blade—so there's no thumbstud to get in the way of your work. A sturdy mid-lock secures the blade.

1896GH**LONEROCK LARGE FIXED, GUT HOOK****STEEL** 8CR13MOV, TITANIUM CARBO-NITRIDE COATING**HANDLE** GLASS-FILLED NYLON, K-TEXTURE GRIP**BLADE** 4-1/4 IN.**OVERALL** 9-3/8 IN.

This modern hunting knife is built to take whatever your hunt can dish out. It offers a big, curved belly and a gut hook for easy skinning. With its thumb recess and heavy mid-spine jimping, this knife was specifically designed to provide multiple grip options and fine control. Kershaw's K-Texture on the handle offers an extra-secure hold. Nylon belt sheath included.

**1895****LONEROCK SMALL FIXED****STEEL** 8CR13MOV, TITANIUM CARBO-NITRIDE COATING**HANDLE** GLASS-FILLED NYLON, K-TEXTURE GRIP**BLADE** 3-3/4 IN.**OVERALL** 8-1/4 IN.

For those who prefer a mid-sized hunting knife, we made the LoneRock 1895. With its thumb recess and heavy mid-spine jimping, this knife was designed to provide multiple grip options and fine control. Kershaw's K-Texture on the handle provides a secure grip, even in slippery conditions. Nylon belt sheath included.

**1894****LONEROCK ZIPIT PRO****STEEL** 8CR13MOV, TITANIUM CARBO-NITRIDE COATING**HANDLE** GLASS-FILLED NYLON, K-TEXTURE GRIP**BLADE** 3-3/8 IN.**OVERALL** 8-15/16 IN.

The Zipit Pro is designed to make gutting quicker and easier. Make long, clean cuts with this slim, tapered blade. To ensure you won't puncture the gut sack, the tip is blunt and rounded. The slim blade is also perfect for skinning legs and other areas where precision is required. Kershaw's K-Texture offers an extra-secure grip. Nylon belt sheath included.





1077 CAMP 10

STEEL 65MN, POWDERCOAT
HANDLE FULL TANG, SURE-GRIP OVERMOLD
BLADE 10 IN.
OVERALL 16 IN.



This camp knife is the right tool for every campsite chore—from clearing brush to making kindling. And, of course, zombies don't stand a chance against this big 10-inch blade with non-reflective powdercoat.



1076 CAMP 14

STEEL 65MN, POWDERCOAT
HANDLE FULL TANG, SURE-GRIP OVERMOLD
BLADE 14 IN.
OVERALL 20 IN.



The new Camp 14 offers 14 inches of brush-clearing and chopping power in a sturdy blade with an ultra-comfortable handle. Features front and rear lanyard holes. The molded sheath provides multiple carry options.



1074 CAMP 18

STEEL 65MN, POWDERCOAT
HANDLE FULL TANG, SURE-GRIP OVERMOLD
BLADE 18 IN.
OVERALL 24 IN.



Our largest camp knife yet, the Camp 18 gives you 18 full inches of tough, sharp cutting capability. You'll be ready for anything with this big, bushwhacking Kershaw blade. The Camp 18 fits in its own molded sheath with multi-carry options.

1290 SPEAR-POINT BAIT KNIFE

STEEL 420J2, BRUSHED FINISH

HANDLE POLYPROPYLENE

BLADE 3-1/2 IN.

OVERALL 7-15/16 IN.



Take this bait—and you'll get a versatile little utility knife that's a perfect addition to the tackle box. The spear-point tip is strong and the razor-sharp edge makes bait and utility cutting easy. Same quality Pro-Grade steel and comfortable handle.

1291 5-1/2 IN. BONING KNIFE

STEEL 420J2, BRUSHED FINISH

HANDLE POLYPROPYLENE

BLADE 5-1/2 IN.

OVERALL 10-3/4 IN.



This new addition to the Pro-Grade lineup is the perfect tool for separating flesh from bones and getting the most out of your catch. The 5-1/2 inch blade is a handy size for taking care of most fish quickly and easily.

1292 5-1/2 IN. GUTTING/SCALING KNIFE

STEEL 420J2, BRUSHED FINISH

HANDLE POLYPROPYLENE

BLADE 5-1/2 IN.

OVERALL 10-3/4 IN.



This is the mid-sized fish-processing knife your tackle box—and your kitchen—needs. It lets you gut and scale your fish quickly and easily. This lightweight knife is agile, razor-sharp, and the right choice for the job.



PURE KNIFE, NO ASSIST

When you don't want a mechanical assist to open your knife, reach for a Kershaw manual. With Kershaw's precision manufacturing, these manual folders open smoothly and easily—even without a mechanical boost. Some accomplish that with a built-in flipper. For others, it's a handy thumbstud. Yet others give you maximum versatility and feature both.



1760 SKYLINE

BLADE SANDVIK 14C28N, BEAD-BLASTED FINISH

HANDLE TEXTURED G-10

BLADE 3-1/8 IN.

CLOSED 4-1/4 IN.

WEIGHT 2.5 OZ.



The Skyline rates high on knife blogger and reviewer lists of best buys and favorites. And no wonder. It's lightweight, versatile, and a lot of knife in a well-priced package.



1725CB JUNKYARD DOG II

STEEL SANDVIK 14C28N/D2 COMPOSITE, BEAD-BLASTED FINISH

HANDLE TEXTURED G-10

BLADE 3-5/8 IN.

CLOSED 4-7/8 IN.

WEIGHT 5.8 OZ.



Junkyard Dog style with the added cool of a Composite Blade. Tough, wear resistant D2 is on the cutting edge, and high-performance 14C28N is on the spine. And check out the sawtooth Composite Blade joint!

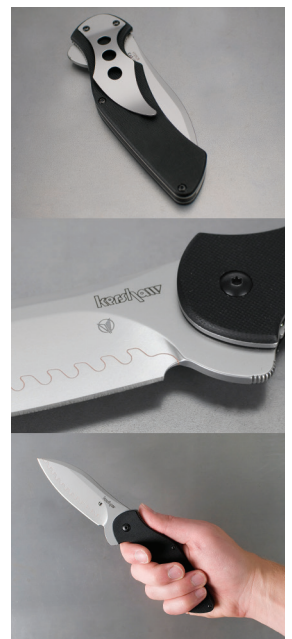

1770 OD-2

STEEL 8CR13MOV, BEAD-BLASTED FINISH

HANDLE GLASS FILLED NYLON

BLADE 2-1/4 IN.

CLOSED 3-1/8 IN.

WEIGHT 1.4 OZ.



The OD-2 (short for "Over-Drive") offers a unique flipper that folds into a recess in the liner when the blade is open to give the OD-2 a sleek, smooth line all the way down. Designed by Lee Williams.





1445 HALF-TON

STEEL 8CR13MOV, SATIN FINISH
HANDLE GLASS-FILLED NYLON, NON-SLIP INSERTS
BLADE 2-1/2 IN.
CLOSED 3-5/8 IN.
WEIGHT 3.3 OZ.



The little guy's always the toughest. The Half-Ton's short, chubby blade works on and on. And just for grins, the pocketclip is shaped like a mini-wrench.



1446 3/4-TON

STEEL 8CR13MOV, BEAD-BLASTED FINISH
HANDLE GLASS-FILLED NYLON, NON-SLIP INSERT
BLADE 2-3/4 IN.
CLOSED 3-7/8 IN.
WEIGHT 3.8 OZ.



Bigger than our popular Half-Ton, more compact than our larger One-Ton; you guessed it, it's the 3/4-Ton and it's the perfect work knife for the guy who wants a knife that's just the right size—in classic black.



1447 ONE-TON

STEEL 8CR13MOV, BEAD-BLASTED FINISH
HANDLE MACHINED G-10 FRONT, 410 BACK
BLADE 3-1/4 IN.
CLOSED 4-5/8 IN.
WEIGHT 4.7 OZ.



If you like a wider blade, but need a bigger knife, then the One-Ton is your knife. It has a wide, fat blade, a machined G-10 front scale, and a 410 stainless back handle.

3700 KURAI

STEEL 8CR13MOV, TITANIUM CARBO-NITRIDE COATING

HANDLE ALUMINUM

BLADE 2-1/2 IN.

CLOSED 3-1/2 IN.

WEIGHT 2.3 OZ.



This awesome little pocketknife has enough style to be a gentleman's dress knife—yet it's tough and versatile enough to carry everyday. A drop-point blade with titanium carbo-nitride coating provides the versatility; aluminum scales provide the style. Includes deep-carry pocketclip.



3410 CHILL

BLADE 8CR13MOV, BEAD-BLASTED FINISH

HANDLE TEXTURED G-10

BLADE 3-1/8 IN.

CLOSED 3-7/8 IN.

WEIGHT 2.0 OZ.



The Chill offers clean lines and great performance. It not only offers cool good looks, but also opens easily with the built-in flipper. Designed by RJ Martin.



1920 SELECT FIRE

STEEL 8CR13MOV, BEAD-BLASTED FINISH

HANDLE GLASS-FILLED NYLON

BLADE 3- 3/8 IN.

CLOSED 4 - 1/4 IN.

WEIGHT 5.3 OZ.

1/4" HEX DRIVE AND ASSORTED BITS



The Select Fire makes a great addition to every tool and truck box. It offers a big, useful blade, plus onboard 4-piece bit set with two flathead and two crosshead bits, bit driver, and a ruler on the bit-drive shaft. There's even a handy bottle opener built in. Designed by Grant & Gavin Hawk.





1060 BLACK HORSE II

STEEL 8CR13MOV, SATIN FINISH

HANDLE CO-POLYMER

BLADE 3-3/4 IN.

CLOSED 4-7/8 IN.

WEIGHT 4.6 OZ.



Simply a great work knife. The clip-point blade configuration deftly accomplishes every job you ask it to, and the durable, co-polymer handle provides a secure grip. Includes sheath.



1045 BLACK COLT II

STEEL 8CR13MOV, SATIN FINISH

HANDLE CO-POLYMER

BLADE 3 IN.

CLOSED 4-1/8 IN.

WEIGHT 3.5 OZ.



This tough little work knife's clip-point blade configuration tackles a variety of tasks, while the durable, co-polymer handle provides a secure grip. Includes sheath.



3160 CROWN

STEEL 8CR13MOV, SATIN FINISH

HANDLE SATIN-FINISH STEEL, POLISHED MICARTA®

BLADE 3-1/4 IN.

CLOSED 4-1/4 IN.

WEIGHT 3.9 OZ.



Polish your image with the Kershaw Crown. From its satin-polished blades and bolsters to its handsome polished Micarta® scales, this is a classic gentleman's knife.

3000 D.W.O.

STEEL 8CR13MOV, SATIN FINISH

HANDLE CO-POLYMER

BLADE 2-3/8 IN.

CLOSED 3-1/4 IN.

WEIGHT 1.6 OZ.

RED D.W.O. 3000RD



The D.W.O.'s small-but-mighty clip-point blade is perfect for taking on all those little tasks around the house or shop; the ribbed co-polymer handle provides an extra-secure and comfortable grip.



2825 SILVER SPUR II

STEEL AUS6A, SATIN FINISH

HANDLE ALUMINUM

BLADE 2-1/4 IN.

CLOSED 3 IN.

WEIGHT 0.9 OZ.



SILVER SPUR 2800

BLADE 1-7/8 IN.

CLOSED 2-1/2 IN.

WEIGHT 0.6 OZ.

The Silver Spur offers a razor-sharp blade and a secure back lock in two handy sizes. The ribbed handle provides a secure grip.

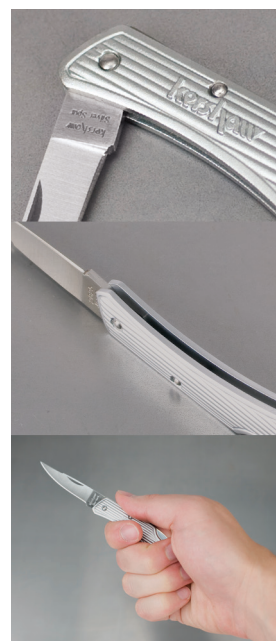

3140 WILDCAT RIDGE

STEEL 8CR13MOV, SATIN FINISH

HANDLE STAINLESS STEEL, CROSS-GROOVED ABS INLAY

BLADE 3-1/2 IN.

CLOSED 4-7/8 IN.

WEIGHT 4.3 OZ.

INCLUDES NYLON SHEATH



SHEATH BLACK GULCH 3120

BLADE 3 IN.

CLOSED 4-1/8 IN.

WEIGHT 4.3 OZ.

NO SHEATH CORRAL CREEK 3115

BLADE 2-1/2 IN.

CLOSED 3-3/8 IN.

WEIGHT 2.2 OZ.

NO SHEATH CORRAL CREEK SHEEPSFOOT 3115BT

BLADE 2-1/2 IN.

CLOSED 3-3/8 IN.

WEIGHT 2.2 OZ.

NO SHEATH GRANT COUNTY 3100

BLADE 1-7/8 IN.

CLOSED 2-5/8 IN.

WEIGHT 1.2 OZ.



EASY, ONE-HANDED OPENING

SpeedSafe® is the patented, assisted opening mechanism pioneered by Kershaw that makes it fast and easy to open a knife one-handed. Many SpeedSafe assisted folders are ambidextrous—and open with a convenient flipper or a thumbstud on both sides of the blade. To open a SpeedSafe knife, the user must apply manual pressure to overcome the resistance of the torsion bar. This means that SpeedSafe knives do not meet the definition of a switchblade; they do not open with the push of a button or by gravity alone. Once open, the blade locks safely into position until the user releases it. SpeedSafe makes one-handed opening convenient, simple, and safe.



SPEEDSAFE

1880 ECHELON

STEEL SANDVIK 14C28N, SATIN FINISH
HANDLE MACHINED TRANSLUCENT G-10
BLADE 3-1/4 IN.
CLOSED 4 IN.
WEIGHT 2.9 OZ.



Get great looks and solid performance. The natural G-10 handle is semi-transparent so you can see the SpeedSafe assisted opening mechanism on the inside. Includes our reversible deep-carry pocketclip.



1870 KNOCKOUT

STEEL SANDVIK 14C28N, STONEWASHED FINISH
HANDLE MACHINED ALUMINUM FRONT, ALUMINUM BACK
BLADE 3-1/4 IN.
CLOSED 4-5/8 IN.
WEIGHT 3.4 OZ.



The Knockout looks great, but the reason it bears this name is that we've "knocked out" a piece of the machined aluminum handle and inset a stainless-steel plate to create the Sub-Frame Lock—and a knife that's lightweight, yet strong. Includes our deep-carry clip.



1780CB RAKE

STEEL SANDVIK 14C28N/D2, BEAD-BLASTED FINISH
HANDLE TEXTURED G-10
BLADE 3-1/2 IN.
CLOSED 4-5/8 IN.
WEIGHT 5.4 OZ.



The Rake's Composite Blade has tough, wear-resistant D2 steel on the cutting edge and high-performance Sandvik 14C28N on the spine. The extra-wide blade with its curved belly provides ample slicing and slashing capability. A clipped point preserves piercing power.





1860 PISTON

STEEL SANDVIK 14C28N, STONEWASHED FINISH

HANDLE MACHINED G-10

BLADE 3-1/2 IN.

CLOSED 5 IN.

WEIGHT 4 OZ.



Unique cuts on the handle and blade give the new Piston a great look. While the Piston is a larger knife, its lightweight G-10 handles make it light enough for everyday carry. The Piston features our Inset Liner Lock and Quad-Carry pocketclip.



1670BLK BLUR

STEEL SANDVIK 14C28N, BEAD-BLASTED FINISH

HANDLE 6061-T6 ANODIZED ALUMINUM, TRAC-TEC INSERTS

BLADE 3-3/8 IN.

CLOSED 4-1/2 IN.

WEIGHT 3.9 OZ.

BLACK BLUR SERRATED 1670BLKST



Get a grip on one of our toughest, most versatile knives—the Blur. Its slightly recurved blade is ideal for slicing, slashing, or pulling cuts. This multi-task-ready blade is paired with a lightweight anodized aluminum handle and Trac-Tec inserts for a secure grip, even in slippery conditions.



1670OLBLK + 1670DSBLK BLUR

STEEL SANDVIK 14C28N, DLC COATING

HANDLE 6061-T6 ANODIZED ALUMINUM, TRAC-TEC INSERTS

BLADE 3-3/8 IN.

CLOSED 4-1/2 IN.

WEIGHT 3.9 OZ.



DESERT SAND BLUR 1670DSBLK

OLIVE DRAB BLUR 1670OLBLK

The versatile Blur also comes in desert sand and olive drab—some of our newest colors.

1670S30V S30V BLUR

STEEL S30V, STONEWASHED FINISH

HANDLE 6061-T6 ANODIZED ALUMINUM, TRAC-TEC INSERTS

BLADE 3-3/8 IN.

CLOSED 4-1/2 IN.

WEIGHT 4.0 OZ.



Want a premium Blur? This is it. The S30V blade takes and holds an edge extremely well; it's tough and wear resistant, too. The S30V Blur shares the same anodized aluminum handle with the rest of the Blur family.



1670TBLKST TANTO BLUR

STEEL SANDVIK 14C28N, DLC COATING

HANDLE 6061-T6 ANODIZED ALUMINUM, TRAC-TEC INSERTS

BLADE 3-3/8 IN.

CLOSED 4-1/2 IN.

WEIGHT 3.8 OZ.



This Blur offers tactical styling with a partially serrated tanto blade. Black DLC coating and anodized aluminum handles complete its discrete, matte look.



1670GBBLKST BLUR GLASSBREAKER

STEEL SANDVIK 14C28N, DLC COATING

HANDLE 6061-T6 ANODIZED ALUMINUM, TRAC-TEC INSERTS

BLADE 3-3/8 IN.

CLOSED 4-1/2 IN.

WEIGHT 4.0 OZ.



The Blur Glassbreaker has the added functionality of a carbide glassbreaker tip built into the handle. Add that to the Blur's sure-grip, contoured handle and recurved blade with partial serration, and you've got a truly versatile knife, ready to handle just about anything.





1550 BLACKOUT

STEEL SANDVIK 14C28N, DLC COATING

HANDLE GLASS-FILLED NYLON

BLADE 3-1/4 IN.

CLOSED 4-1/2 IN.

WEIGHT 3.5 OZ.

SERRATED 1550ST



When it was first introduced, the Blackout was selected as the Blade Show's Best Buy. And it still is. Great for work, outdoors, or everyday carrying, the Blackout is a Kershaw best seller. Single thumbstud positioned for right-handed blade deployment.



1560 WHIRLWIND

STEEL SANDVIK 14C28N, SATIN FINISH

HANDLE GLASS-FILLED NYLON

BLADE 3-1/4 IN.

CLOSED 4-1/2 IN.

WEIGHT 3.5 OZ.

SERRATED 1560ST



One of the first—and still one of our best-selling SpeedSafe knives. The Whirlwind is a big handful of a knife, perfect for work or as a larger EDC. Single thumbstud positioned for right-handed blade deployment.



1620 SCALLION

STEEL 420HC, BEAD-BLASTED FINISH

HANDLE GLASS-FILLED NYLON

LINER 410

BLADE 2-3/8 IN.

CLOSED 3-1/2 IN.

WEIGHT 2.3 OZ.

SERRATED 1620ST



The Scallion is perfect for everyday carry and cuts way down on the intimidation factor. Tip-Lock for added safety.



1620RD SCALLION

STEEL 420HC, BEAD-BLASTED FINISH
HANDLE 6061-T6 ANODIZED ALUMINUM
BLADE 2-3/8 IN.
CLOSED 3-1/2 IN.
WEIGHT 2.6 OZ.



The popular Scallion comes in a selection of handle choices, including this eye-catching anodized aluminum red. Tip-lock for added safety.



1620FL SCALLION

STEEL 420HC, BEAD-BLASTED FINISH
HANDLE 410, BEAD-BLASTED FINISH
BLADE 2-3/8 IN.
CLOSED 3-1/2 IN.
WEIGHT 2.9 OZ.

SERRATED 1620FLST



This Scallion is pure stainless steel with a super-secure frame lock. Tip-Lock for added safety.



1620VIB RAINBOW SCALLION

STEEL 420HC, TITANIUM-OXIDE RAINBOW COATING
HANDLE 410, TITANIUM-OXIDE RAINBOW COATING
BLADE 2-3/8 IN.
CLOSED 3-1/2 IN.
WEIGHT 2.9 OZ.



If one color just isn't enough, try the Rainbow Scallion and get them all. The secret to this rainbow colors is in the scratch-resistant titanium-oxide coating. Tip-Lock for added safety.





1600 CHIVE

STEEL 420HC, BEAD-BLASTED FINISH
HANDLE 410, BEAD-BLASTED FINISH
BLADE 1-15/16 IN.
CLOSED 2-7/8 IN.
WEIGHT 1.8 OZ.



Still one of our best-selling knives, this Chive is pure stainless steel with an attractive bead-blasted finish. Tip-Lock for added safety.



1600BLK BLACK CHIVE

STEEL 420HC, POLISHED DLC COATING
HANDLE 410, POLISHED DLC COATING
BLADE 1-15/16 IN.
CLOSED 2-7/8 IN.
WEIGHT 1.8 OZ.



Black DLC coated for a sophisticated look in a small pocket-knife. Tip-Lock for added safety. 2005 Blade Show winner for Most Innovative American Design.



1600PINK CHIVE

STEEL 420HC, BEAD-BLASTED FINISH
HANDLE 6061-T6 ANODIZED ALUMINUM
BLADE 1-15/16 IN.
CLOSED 2-7/8 IN.
WEIGHT 1.8 OZ.



Pretty in pink. This small knife is a pocket- or purse-perfect companion for everyday carry. Tip-Lock for added safety.

1600VIB RAINBOW CHIVE

STEEL 420HC, TITANIUM-OXIDE RAINBOW COATING

HANDLE 410, TITANIUM-OXIDE RAINBOW COATING

BLADE 1-15/16 IN.

CLOSED 2-7/8 IN.

WEIGHT 1.9 OZ.



Titanium-oxide rainbow coating makes this the most eye-catching small knife ever. Tip-Lock for added safety.



1840 SHALLOT

STEEL SANDVIK 14C28N, BEAD-BLASTED FINISH

HANDLE 410, BEAD-BLASTED FINISH

BLADE 3-1/2 IN.

CLOSED 4-3/8 IN.

WEIGHT 4.3 OZ.

SERRATED 1840ST

BLACK SHALLOT 1840CKT/1840CKTST (Serrated)

STEEL SANDVIK 14C28N, DLC COATING

HANDLE 410, DLC COATING



The Shallot offers a 3-1/2 inch blade and an ergonomically curved handle. Choose silver or black, plain or partially serrated edge.



1730SS ZINGSS

STEEL 8CR13MOV, BEAD-BLASTED FINISH

HANDLE 410, BEAD-BLASTED FINISH

BLADE 3 IN.

CLOSED 3-7/8 IN.

WEIGHT 3.3 OZ.



Get the Zing of pure steel—now with SpeedSafe. With its unique design and pocket-perfect size, the Zing is one of our most popular knives. Now we're taking it to a new level with the Zing SS. It's larger, yet slimmer and offers the security of a frame lock. Designed by RJ Martin.





1660 LEEK

STEEL SANDVIK 14C28N, BEAD-BLASTED FINISH

HANDLE 410, BEAD-BLASTED FINISH

BLADE 3 IN.

CLOSED 4 IN.

WEIGHT 3.0 OZ.

SERRATED 1660ST



This is the Leek, straight-up. All stainless steel, all the time. Perfect for frame lock lovers; plus a Tip-Lock for added security. Choose smooth or partially serrated edge.



1660VIB RAINBOW LEEK

STEEL SANDVIK 14C28N, TITANIUM-OXIDE RAINBOW COATING

HANDLE 410, TITANIUM-OXIDE RAINBOW COATING

BLADE 3 IN.

CLOSED 4 IN.

WEIGHT 3.0 OZ.



The Leek is a step up in blade length from the Scallion. Yet, the three-inch blade fits in a pleasingly narrow profile. Scratch-resistant titanium-oxide coating. Tip-Lock for added safety.



1660CKT LEEK

STEEL SANDVIK 14C28N, DLC COATING

HANDLE 410, DLC COATING

BLADE 3 IN.

CLOSED 4 IN.

WEIGHT 3.0 OZ.

SERRATED 1660CKTST



For a versatile Leek in basic black, choose this handsome knife. Your choice of partially serrated or smooth edge. Tip-Lock for added safety.



1660TGRYST RANDOMLEEK

STEEL S30V, PVD COATING
HANDLE 410, PVD COATING
BLADE 3 IN.
CLOSED 4 IN.
WEIGHT 3.0 OZ.



For quality and value, the Random Leek is not a random choice. The blade is made of super-tough, corrosion resistant S30V with a matte PVD coating. Partial serration provides additional cutting versatility. Stainless steel handles with the same PVD coating and a sturdy frame lock completes the picture. Includes tip-lock for added safety.



1660CB COMPOSITE BLADE LEEK

STEEL SANDVIK 14C28N/D2 COMPOSITE, BEAD-BLASTED FINISH
HANDLE 410, BEAD-BLASTED FINISH
BLADE 3 IN.
CLOSED 4 IN.
WEIGHT 3.1 OZ.



The Leek is just that much more awesome with Kershaw's patent-pending Composite Blade. D2 on the cutting edge, 14C28N on the spine. Tip-Lock for added safety.



1820 NEEDS WORK

STEEL SANDVIK 14C28N, BEAD-BLASTED FINISH
HANDLE GLASS-FILLED NYLON
BLADE 2-3/4 IN.
CLOSED 4-1/8 IN.
WEIGHT 4 OZ.



A lightweight utility-style knife that's ideal for everyday carry. Blade shape offers excellent chopping, slicing, and piercing strength.





1835TBLKST KURO

STEEL 8CR13MOV, BLACK OXIDE COATING

HANDLE GLASS-FILLED NYLON

BLADE 3-1/8 IN.

HANDLE 4-1/8 IN.

WEIGHT 3.2 OZ.



A modified tanto blade with partial serration is paired with textured, glass-filled nylon scales in this all-black beauty. Access the SpeedSafe assisted opening quickly and easily with an ambidextrous flipper. Drilled to accept a lanyard. An impressive look at a value price.



1830 OSO SWEET

STEEL 8CR13MOV, SATIN FINISH

HANDLE GLASS-FILLED NYLON

BLADE 3 IN.

CLOSED 4 IN.

WEIGHT 3 OZ.



This is indeed one sweet pocketknife. With a classic drop-point blade for cutting versatility, SpeedSafe assisted opening, and an ambidextrous flipper, it's the right choice for everyone.



**Blade Magazine's
2012 Best Buy of the Year**



1555TI CRYO

STEEL 8CR13MOV, TITANIUM CARBO-NITRIDE COATING

HANDLE 410, TITANIUM CARBO-NITRIDE COATING

BLADE 2-3/4 IN.

CLOSED 3-3/4 IN.

WEIGHT 4.1 OZ.



Built in pure steel with matte grey titanium carbo-nitride coating on both blade and handle, the Cryo opens quickly with flipper or thumbstud. It also features a sturdy framelock with lockbar stabilization. Designed by Rick Hinderer.

1970
BURST

STEEL 8CR13MOV, STONEWASHED FINISH
HANDLE GLASS-FILLED NYLON SCALES
BLADE 3 IN.
CLOSED 4-1/8 IN.
WEIGHT 3.4 OZ.

SERRATED 1970ST



The aggressive, spiked look of the Burst is sure to draw the eye and plenty of positive comments. And check out that flipper. We've directed the blade grind all the way down the flipper for a sweeping line and an awesome look.



1985ST
RJI

STEEL 8CR13MOV, TITANIUM CARBO-NITRIDE COATING
HANDLE MACHINED G-10
BLADE 3-1/2 IN.
CLOSED 4-5/8 IN.
WEIGHT 4.5 OZ.



The RJ I's blade design and grind provides a slightly curved belly with plenty of slicing power, plus a flat-ground tanto tip that's significantly thicker than comparable tantos so you can take on piercing tasks with no fear. Designed by RJ Martin.



1980ST
RJII

STEEL 8CR13MOV, TITANIUM CARBO-NITRIDE COATING
HANDLE MACHINED G-10
BLADE 3 IN.
CLOSED 4 IN.
WEIGHT 3.4 OZ.



Like the RJ I, but want a slightly smaller knife? The RJ II is for you. It offers all the same features and tactical style, but with a smaller 3-1/8-inch blade.





3650 VOLT II

STEEL 8CR13MOV, BEAD-BLASTED FINISH

HANDLE GLASS-FILLED NYLON

BLADE 3-1/4 IN.

CLOSED 3-7/8 IN.

WEIGHT 3.3 OZ.

SERRATED 3650ST



The Volt II features the same versatile blade and handle style as the original Kershaw Volt—but at a value price. Volt IIs designed by RJ Martin.



3650CKTST BLACK VOLT II

STEEL 8CR13MOV, BLACK OXIDE COATING

HANDLE GLASS-FILLED NYLON

BLADE 3-1/4 IN.

CLOSED 3-7/8 IN.

WEIGHT 3.3 OZ.



You asked for it, you've got it. Now the same versatile blade and handle style as the original Volt II is available in sleek black from the tip of the blade to the butt of the handle.

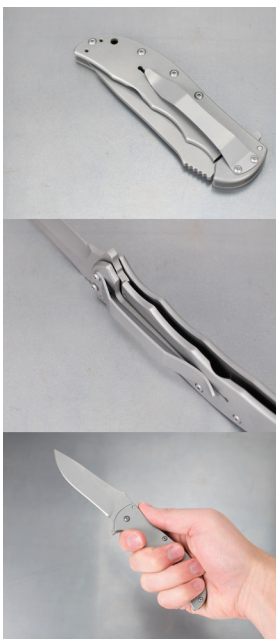

3655 VOLT SS

STEEL 8CR13MOV, BEAD-BLASTED FINISH

HANDLE 410, BEAD-BLASTED FINISH

BLADE 3-1/2 IN.

CLOSED 4-1/4 IN.

WEIGHT 4.3 OZ.



High voltage looks and a slimmer profile. The Volt SS picks up where the Volt II left off—and gets even better. While it's larger than the original, it's slimmer, features a solid frame lock, and is all stainless steel from tip to butt.

1990 BRAWLER

STEEL 8CR13MOV, BLACK OXIDE COATING

HANDLE GLASS-FILLED NYLON

BLADE 3 IN.

CLOSED 4-1/8 IN

WEIGHT 3.8 OZ.



Get great style and great function in a value-priced knife with the Kershaw Brawler. In addition to amazing looks, the Brawler offers SpeedSafe, a modified tanto blade with an extra-thick tip, light weight, and quad-carry options.



1605 CLASH

STEEL 8CR13MOV, BEAD-BLASTED FINISH

HANDLE GLASS-FILLED NYLON

BLADE 3-1/8 IN.

CLOSED 4-1/4 IN.

WEIGHT 4.2 OZ.

SERRATED 1605ST



The Clash's drop-point blade with just a hint of recurve is a versatile style that excels at a wide variety of tasks. An ambidextrous flipper makes it a great choice for left- or right-handers.



1605CKTST BLACK CLASH

STEEL 8CR13MOV, BLACK OXIDE COATING

HANDLE GLASS-FILLED NYLON

BLADE 3-1/8 IN.

CLOSED 4-1/4 IN.

WEIGHT 4.3 OZ.



A drop-point blade with just a little recurve enables this multipurpose knife to handle just about any cutting job, from slicing to rope cutting. Handsome black oxide blade coating and black scales make it rock extra hard.





8000OL FUNXION OUTDOOR

STEEL 8CR13MOV, SATIN FINISH
HANDLE ALUMINUM, RUBBER INSERT
BLADE 3 IN.
CLOSED 4-1/4 IN.
WEIGHT 5.5 OZ.



The Funxion Outdoor provides a big, drop-point blade, a saw blade, and a swing-out carabiner-style clip that attaches easily to belt or pack. The Kershaw deep-carry pocketclip enables secure and discreet pocket carry. The blade and the tools each have a separate locking liner for safety.



8200RD FUNXION DIY

STEEL 8CR13MOV, SATIN FINISH
HANDLE ALUMINUM, RUBBER INSERT
BLADE 3 IN.
CLOSED 4-1/4 IN.
WEIGHT 5.2 OZ.



In addition to a SpeedSafe assisted knife blade, the Funxion DIY provides a selection of handy tools perfect for taking on all those around-the-house tasks. It includes a flathead screwdriver tip, hex wrench, carabiner clip, and—very important—a bottlecap lifter. A separate locking liner for the blade and the tools ensures safety. Includes deep-carry pocketclip.



8100GRYST FUNXION EMT

STEEL 8CR13MOV, BLACK OXIDE COATING
HANDLE ALUMINUM, RUBBER INSERT
BLADE 3 IN.
CLOSED 4-1/4 IN.
WEIGHT 5.2 OZ.



The Funxion EMT features a modified tanto blade with partial serration, cord cutter, hex wrench, carabiner clip and carbide glassbreaker tip. An aluminum handle lightens the tool's weight, a separate locking liner for the blade and for the tools ensures safety. Includes deep-carry pocketclip.

GET OUTSIDE — AND CARRY A GREAT KNIFE

For fishing, hunting, camping, hiking, climbing—and just about any other outdoor sport—you're going to want to have a trusty Kershaw along. These are true sporting knives made by a sporting goods company. From our American-Made Hunters line to our Pro-Grade Specialty Fish & Game Knives and from our selection of handy campsite gear to our famous Blade Traders, these tools are must-haves whether you're working or playing outside. For extra convenience, most include sheaths, blade guards, or storage cases. Whatever your sport, you'll find the sporting companion you need in this collection of great outdoors knives from Kershaw.



OUTDOORS



1081 MINI SKINNER

STEEL SANDVIK 14C28N, STONEWASHED FINISH
HANDLE TEXTURED G-10 SCALES
BLADE 2 IN.
OVERALL 4-3/4 IN.
WEIGHT 1.6 OZ.



Good things come in small sheaths, too. The Mini Skinner is shaped like our popular Skinning Knife. It offers a 2-in. full-tang blade that's ideal for smaller game. Includes sheath.



1080 SKINNING KNIFE

STEEL SANDVIK 14C28N, STONEWASHED FINISH
HANDLE TEXTURED G-10 SCALES
BLADE 2-3/8 IN.
OVERALL 6 IN.
WEIGHT 3.6 OZ.

ORANGE SKINNING KNIFE 1080OR



Part of the Kershaw American-Made Hunters series. Super-sharp and highly maneuverable, this Skinning Knife is the one you'll reach for time and time again. Basic black or safety orange scales. Includes sheath.



1082 FIELD KNIFE

STEEL SANDVIK 14C28N, STONEWASHED FINISH
HANDLE TEXTURED G-10 SCALES
BLADE 3-1/4 IN.
OVERALL 7-1/4 IN.
WEIGHT 4.0 OZ.

ORANGE FIELD KNIFE 1082OR



Part of the Kershaw American-Made Hunters series. The full-tang Field Knife is the perfect all-around hunting knife, moving from field to campsite tasks with ease. Basic black or safety orange scales. Includes sheath.

1085 DISKIN HUNTER

STEEL SANDVIK 14C28N, STONEWASHED FINISH

HANDLE TEXTURED G-10 SCALES

BLADE 4-5/8 IN.

OVERALL 9-1/2 IN.

WEIGHT 5 OZ.



This is a big, bold fixed-blade knife with a slim, comfortable handle. Part of the American-Made Hunters series. Includes sheath. Designed by Matt Diskin.



1029 BEAR HUNTER II

STEEL 8CR13MOV, SATIN FINISH

HANDLE CO-POLYMER

BLADE 4-1/2 IN.

OVERALL 9-1/2 IN.

WEIGHT 5.3 OZ.



It's big, bold, and incredibly practical. This quality blade steel holds its edge and the sure-grip handle handles just about anything. Includes sheath.



1028 ANTELOPE HUNTER II

STEEL 8CR13MOV, SATIN FINISH

HANDLE CO-POLYMER

BLADE 3-5/8 IN.

OVERALL 8 IN.

WEIGHT 3.6 OZ.

ORANGE ANTELOPE HUNTER II 1028OR



The Antelope Hunter II's high-performance blade steel holds its edge while the contoured handle offers a secure grip in any conditions. Includes sheath. Safety orange or basic black handle.





1010 ROUGHNECK

STEEL AUS6A, SATIN FINISH
HANDLE CO-POLYMER
BLADE 6-1/4 IN. PARTIALLY SERRATED SPINE
OVERALL 11-1/8 IN.
WEIGHT 6.3 OZ.



The Roughneck is one sturdy, very practical hunting knife. Razor-sharp edge on one side of the blade, partial serration on the other. Includes sheath.



1620C CAMO SCALLION

STEEL 420HC, BEAD-BLASTED FINISH
HANDLE 6061-T6 ANODIZED ALUMINUM, REALTREE®
 HARDWOODS HD PATTERN
BLADE 2-3/8 IN.
CLOSED 3-1/2 IN.
WEIGHT 2.6 OZ.



The Camo Scallion is the perfect mid-sized knife to accompany you on your next hunting trip—or for everyday carry. The RealTree camo pattern is applied to lightweight anodized aluminum handles for a durable, scratch-resistant finish. Tip-Lock for added safety.



1060RT CAMO BLACK HORSE II

STEEL 8CR13MOV, SATIN FINISH
HANDLE CO-POLYMER, REALTREE® HARDWOODS HD PATTERN
BLADE 3-3/4 IN.
CLOSED 4-7/8 IN.
WEIGHT 4.6 OZ.



RealTree camo, a versatile blade, and a sure-grip handle makes Kershaw's Camo Black Horse II one of our most popular hunters. Includes sheath.

1050 FOLDING FIELD

STEEL 8CR13MOV, MIRROR POLISH

HANDLE BRASS BOLSTERS, PMMA PLASTIC SCALES

BLADE 3-1/8 IN.

CLOSED 4-3/4 IN.

WEIGHT 9 OZ.



Back by popular demand, the Kershaw Folding Field knife is just about as classic as a hunting knife can get. For many years, it was our flagship knife—and now it's back. With its gleaming brass bolster and butt plus high-quality Kershaw manufacturing, now is the right time to snap it up! Includes sheath.



2520 ZIPIT

STEEL 420J2, SATIN FINISH

FINGER HOLE RUBBER INSERT

BLADE 1/2 IN.

OVERALL 3-3/4 IN.

WEIGHT 1.6 OZ.

ORANGEZIPIT 2520OR

Got a favorite hunting knife and just need the gut hook? Get the Ziplt. Rubber insert keeps finger comfortable during use, handy size makes it easy to pack with your gear.



1120 TASKMASTER SHEARS

BLADE 3-1/2 IN. WITH ONE EDGE SERRATED

OVERALL 8-7/8 IN.

WEIGHT 5.1 OZ.



In addition to handling a wide variety of cutting tasks, these shears have a nutcracker, jar opener, bone notch, lid lifter and screwdriver tips. For easy cleaning, the blades fully separate.





1210 SKEETER I

HANDLE SOFT-GRIP OVER-MOLD FINGER HOLES

OVERALL 4-1/4 IN.

WEIGHT 0.8 OZ.

SKEETER II (MICRO-SERRATED) 1215

Compact and durable, Skeeter fly-tying scissors are designed to cut through a wide variety of materials with ease. An extra fine point provides for precise trimming. The comfortable finger loops provide precise control during use.



1259 9 IN. FILLET

STEEL 420J2, SATIN FINISH

HANDLE CO-POLYMER

BLADE 9-1/4 IN.

CLOSED 14-1/4 IN.

WEIGHT 4 OZ.

7-1/2 IN. FILLET 1257

BLADE 6 IN.

OVERALL 13-1/8 IN.

WEIGHT 3.7 OZ.



A flexible blade with soft touch, sure-grip handle; neon accents make it easy to spot in a marine environment. Choose 7½-inch for small-to-medium-sized fish, 9-inch for larger fish. Includes ABS sheath.



1256 FOLDING FILLET

STEEL 420J2, SATIN FINISH

HANDLE TEXTURED PLASTIC

BLADE 6 IN.

OVERALL 13-1/8 IN.

WEIGHT 5.6 OZ.



The Kershaw Folding Fillet provides the same top performance all Kershaw fillet knives have to offer—just in a more compact space. Includes lanyard hole and fold-out cleaning spoon.

PRO-GRADE SERIES

Specialty Fish & Game Knives

STEEL 420J2, BRUSHED FINISH
HANDLE POLYPROPYLENE



The Kershaw Pro-Grade Specialty Fish & Game series is all about having the right tool for the job. All have a premium, corrosion-resistant blade with just the right amount of flex to make the job easier. The handle is a proven design that really lets your hand lock into place. In addition, all Pro-Grade knives are designed to be lightweight so fish and game processing is less tiring. Includes blade protector with slits to allow air to circulate.

1282
12IN. CIMETER
BLADE 12 IN.
OVERALL 17-1/2 IN.
WEIGHT 8.6 OZ.

1280GE
10 IN. BREAKING KNIFE, GRANTON EDGE
BLADE 10 IN.
OVERALL 15-3/4 IN.
WEIGHT 6 OZ.

1280
10IN. CURVED BREAKING
BLADE 10 IN.
OVERALL 15-1/2 IN.
WEIGHT 6.0 OZ.

1289
9IN. NARROW FILLET
BLADE 9 IN.
OVERALL 14-1/4 IN.
WEIGHT 4.0 OZ.

1288SH
8-1/2 IN. SPOON-HANDLE FILLET
BLADE 8-1/4 IN.
OVERALL 16 IN.
WEIGHT 3 OZ.

1288BK
8 IN. BREAKING
BLADE 8 IN.
OVERALL 13-1/4 IN.
WEIGHT 4.8 OZ.

1287
7-1/2 IN. NARROW FILLET
BLADE 7-1/2 IN.
OVERALL 12-3/4 IN.
WEIGHT 4.0 OZ.





1098AK ALASKAN BLADE TRADER

BT-11 SKINNING+GUT-HOOK AUS6A, SATIN FINISH

BT-3 HUNTING 420J2, SATIN FINISH

BT-5 SAW SAW STEEL, SATIN FINISH

BT-H HANDLE CO-POLYMER

SKINNING BLADE 4-1/4 IN.

HUNTING BLADE 3-1/2 IN.

SAW BLADE 5-1/2 IN.

WEIGHT 11.6 OZ. (TOTAL)



1094HBT HUNTER'S BLADE TRADER

STEEL 420J2, SAW STEEL, SATIN FINISH

BT-H HANDLE CO-POLYMER

BT-3 HUNTING BLADE 3-1/2 IN.

BT-5 SAW BLADE 5-1/2 IN.

WEIGHT 9.2 OZ. (TOTAL)



1095SBT SPORTSMAN'S BLADE TRADER

STEEL 420J2, SAW STEEL, SATIN FINISH

BT-H HANDLE CO-POLYMER

BT-3 HUNTING BLADE 3-1/2 IN.

BT-5 SAW BLADE 5-1/2 IN.

BT-2 FILLET BLADE 5-1/2 IN.

WEIGHT 13.1 OZ. (TOTAL)



1096FBT FISHERMAN'S BLADE TRADER

STEEL 420J2, SATIN FINISH
BT-H HANDLE CO-POLYMER
BT-12 FILLET BLADE-A 7 IN.
BT-13 FILLET BLADE-B 9 IN.
WEIGHT 8.9 OZ. (TOTAL)



1091CT CAMP-TOOL TRADER COMES WITH TWO HANDLES

STEEL 420J2, SAW STEEL, SATIN FINISH
BT-H HANDLE CO-POLYMER
BT-6 COOK'S BLADE 5-3/4 IN.
BT-2 FILLET BLADE 5-1/2 IN.
BT-5 SAW BLADE 5-1/2 IN.
BT-14 SPATULA 3-5/8 IN.
BT-15 SPOON 3-5/8 IN.
BT-16 FORK 3 IN.
CUTTING BOARD 10-3/4 IN. X 8 IN.
WEIGHT 60.1 OZ. (TOTAL)



1099DBT DELUXE BLADE TRADER

STEEL 420J2, SAW STEEL, SATIN FINISH
BT-H TWO HANDLES CO-POLYMER
BT-6 COOK'S BLADE 5-3/4 IN.
BT-2 FILLET BLADE 5-1/2 IN.
BT-5 SAW BLADE 5-1/2 IN.
BT-7 CARVING BLADE 6-1/8 IN.
BT-8 BREAD BLADE 6-1/8 IN.
BT-4 UTILITY BLADE 4 IN.
WEIGHT 25.6 OZ. (TOTAL)





1018 CAMP AX

STEEL ONE-PIECE, DROP FORGED HIGH-CARBON STEEL
HANDLE NON-SLIP OVER-MOLD
BLADE 3-1/2 IN.
OVERALL 11 IN.
WEIGHT 14.5 OZ.



This sturdy ax is drop forged in a single piece for reliable durability. For secure grip, we added a non-slip handle and a handy sheath to protect the blade.



4351 MILITARY KNIFE

STEEL ONE-PIECE, DROP-FORGED 1.4116 GERMAN STAINLESS STEEL, BEAD-BLASTED FINISH
HANDLE POM SCALES
BLADE 4-1/2 IN.
OVERALL 9 IN.
WEIGHT 4.4 OZ.



The knife's simple shape enables it to handle well, move quickly, and lend itself to a variety of grip styles. Includes sheath with belt/boot clip.

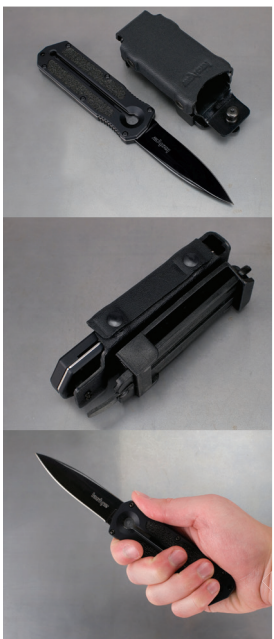

3200 RIPCORD

STEEL SANDVIK 14C28N, POLISHED DLC COATING
HANDLE 6061-T6 ANODIZED ALUMINUM, TRAC-TEC INSERTS
BLADE 3-7/16 IN.
CLOSED 4-3/8 IN.
WEIGHT 4.2 OZ.



The Ripcord's patented design provides the strength and stability of a fixed blade knife, yet stores as compactly as a folding knife. The key is Kershaw's "Out the Front" (OTF) design. With OTF, the blade slides out the front of the handle into a secure, fixed-blade position. A convenient belt sheath doubles as the OTF deployment system to engage or disengage the knife's locking function.



1006K AMPHIBIAN

STEEL 420J2, SATIN FINISH

HANDLE 420J2, FULL-TANG SKELETON, CO-POLYMER INSERT

BLADE 3-3/4 IN. DOUBLE-EDGED, PARTIALLY SERRATED

OVERALL 7-3/4 IN.

WEIGHT 3.2 OZ.



The Amphibian provides all the strength of solid, corrosion-resistant 420J2 stainless steel from tip to pommel, but with a skeleton handle design to reduce weight. A co-polymer insert in the handle assures an excellent grip. Includes a diver's sheath with leg straps and adjustable quick-release buckles.



1008 SEA HUNTER

STEEL 420J2, SATIN FINISH

HANDLE NEON PLASTIC, CO-POLYMER OVER-MOLD

BLADE 3-3/4 IN. DOUBLE-EDGED, PARTIALLY SERRATED

OVERALL 7-3/4 IN.

WEIGHT 3.0 OZ.



Corrosion-resistant 420J2 stainless steel has open-tang construction to reduce weight. Neon accents are easily visible in marine environment. Includes Kydex® multi-function diver's sheath with leg straps and built-in cord and line cutter.

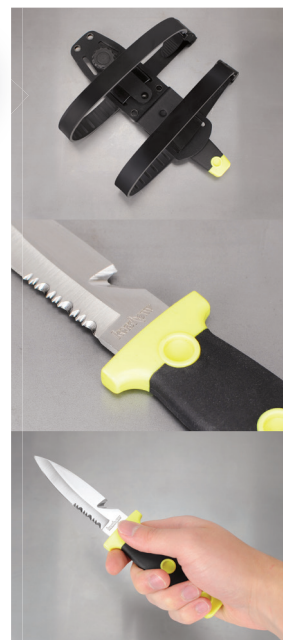

1008BL-P SEA HUNTER

STEEL 420J2, SATIN FINISH

HANDLE NEON PLASTIC, CO-POLYMER OVER-MOLD

BLADE 3-1/2 IN. BLUNT-TIP, DOUBLE-EDGED, PARTIALLY SERRATED

OVERALL 7-5/8 IN.

WEIGHT 3.0 OZ.



Has the same corrosion-resistant 420J2 stainless steel, open-tang construction, and neon accents as the regular Sea Hunter, but with a blunt tip for safety. Includes Kydex® multi-function diver's sheath with leg straps and built-in cord and line cutter.



CONTEMPORARY STYLE, TOP PERFORMANCE

With cutting performance to rival much more expensive sets, Kershaw kitchen cutlery offers high-quality, high-carbon stainless blade steel that takes and holds a brilliantly sharp edge. Soft-touch handles provide a soft-yet-firm, non-slip grip that reduces hand fatigue and makes cutting more comfortable. The clean, contemporary, black and white styling goes with most any kitchen décor. Kershaw offers a dozen of the most-wanted blade styles as well as attractive block sets. The 9900 series is NSF Certified for use in commercial kitchens.



HOUSEWARES



KITCHEN CUTLERY 9900 SERIES

STEEL AUS6A
HANDLE CO-POLYMER



9990
HONING STEEL
STEEL ROD 9 IN. (22.9CM)
OVERALL 14-1/4 IN.
WEIGHT 13.6 OZ.

9970
SLICING
BLADE 9 IN. (22.9CM)
OVERALL 14-1/8 IN.
WEIGHT 3.9 OZ.

9960
BREAD
BLADE 8 IN. (20.3CM)
OVERALL 12-7/8 IN.
WEIGHT 3 OZ.

9945
CHEF'S
BLADE 8 IN. (20.3CM)
OVERALL 13 IN.
WEIGHT 6.1 OZ.

9950
SANTOKU
BLADE 7 IN. (17.8CM)
OVERALL 12 IN.
WEIGHT 3.5 OZ.

9940
CHEF'S
BLADE 6 IN. (15.2CM)
OVERALL 11-3/16 IN.
WEIGHT 4 OZ.

9920
BONING
BLADE 5-1/2 IN. (14.0CM)
OVERALL 10-3/8 IN.
WEIGHT 2.8 OZ.

9922
STEAK
BLADE 4-5/8 IN. (11.8CM)
OVERALL 8-3/16 IN.
WEIGHT 1.6 OZ.

9921
UTILITY
BLADE 4-5/8 IN. (11.8CM)
OVERALL 8-3/16 IN.
WEIGHT 1.5 OZ.

9915
PARING
BLADE 3-3/4 IN. (9.5CM)
OVERALL 7-5/8 IN.
WEIGHT 1.5 OZ.

9910
VEGETABLE
BLADE 3-1/4 IN. (8.2CM)
OVERALL 7-1/4 IN.
WEIGHT 1.4 OZ.

9900
PARING
BLADE 2-7/8 IN. (7.3CM)
OVERALL 7 IN.
WEIGHT 1.4 OZ.



9900-7 9900 BLOCK SET

This seven-piece set has all the kitchen essentials—from Chef's knife to Honing Steel, plus a beautiful hardwood block for storage.

INCLUDES

9940 Chef's
9900 Paring
9921 Utility
9970 Slicing
9990 Honing steel
Kitchen shears
Hardwood block

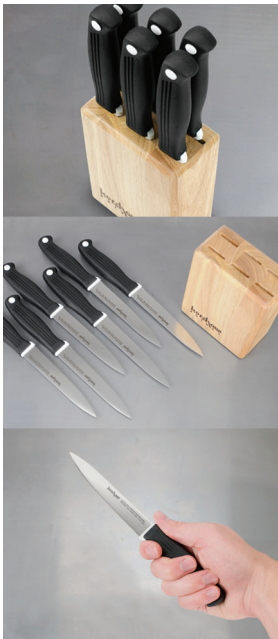

9922-7 STEAK KNIFE SET

Cut your steak with these razor-sharp steak knives and keep more of the juices where they belong—in the steak. You get a set of six serrated steak knives in a handsome hardwood storage block.

INCLUDES

9922 Steak knife (6)
Hardwood block



CB-3 CUTTING BOARD SET

This handy set includes three key pieces no kitchen should be without. The Chef's knife handles most kitchen chores with ease. The Paring knife is perfect for smaller jobs, from peeling to mincing. Cutting on the wooden board helps keep you knives sharper for a longer period of time.

INCLUDES

9940 Chef's
9900 Paring
Wooden cutting board

GET YOUR KERSHAW GEAR HERE

Accessorize the Kershaw way with this collection of new and classic Kershaw gear. Check out our new t-shirts and expanded collection of caps. There's sure to be a color just right for everyone. We also offer tools for keeping a Kershaw knife in top condition. And for Kershaw collectors, there's our handsome nylon storage bag. It's a great way to get your Kershaw on!



ACCESSORIES



1019 FIRE STARTER

SHAFT STEEL MAGNESIUM FIRESTEEL
STRIKER CHROME-PLATED STEEL
HANDLE PLASTIC
SHAFT 1-3/4 IN.
STRIKER 2-3/4 IN.
OVERALL 3-1/8 IN.
WEIGHT 1.1 OZ.

This magnesium fire starter always strikes a spark—even in damp conditions. A molded plastic handle makes it easy to use and a nylon cord keeps it handy when you need it.

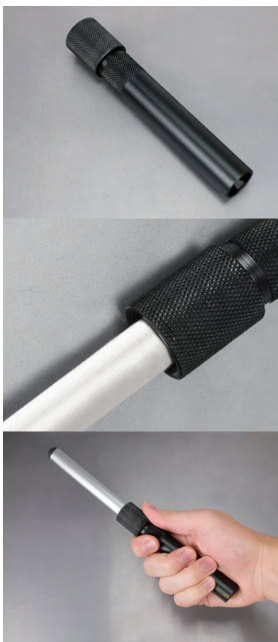

2535 ULTRA-TEK SHARPENER

STEEL 600-GRIT DIAMOND COATED OVAL SHAFT
HANDLE ALUMINUM
SHAFT 3-3/4 IN.
OVERALL 9-1/2 IN.
WEIGHT 2.0 OZ.

600-grit diamond-coated oval shaft lets you put a nice, Kershaw-sharp edge on your knife. Compact size and light weight make it easy to take with you wherever you go.



T TOOL KEY CHAIN T-TOOL

HANDLE TEFLON-COATED ALUMINUM
OVERALL 4 IN.
WEIGHT 0.7 OZ.

This is the right tool for adjusting any Kershaw knife.

INCLUDES
 #1 Crosshead
 T-6 Torx
 T-8 Torx



KERSHAW T-SHIRT

SHIRTMENS

KERSHAW, MENS SM TSHIRT BLACK WITH GREY

SHIRTMENM

KERSHAW, MENS MED TSHIRT BLACK WITH GREY

SHIRTMENL

KERSHAW, MENS LARGE TSHIRT BLACK WITH GREY

SHIRTMENXL

KERSHAW, MENS XL TSHIRT BLACK WITH GREY

SHIRTMENXXL

KERSHAW, MENS XXL TSHIRT BLACK WITH GREY

SHIRTWMS

KERSHAW, WOMANS SM TSHIRT BLACK WITH GREY

SHIRTWMM

KERSHAW, WOMANS MED TSHIRT BLACK WITH GREY

SHIRTWML

KERSHAW, WOMANS LARGE TSHIRT BLACK WITH GREY

SHIRTWML

KERSHAW, WOMANS XLARGE TSHIRT BLACK WITH GREY

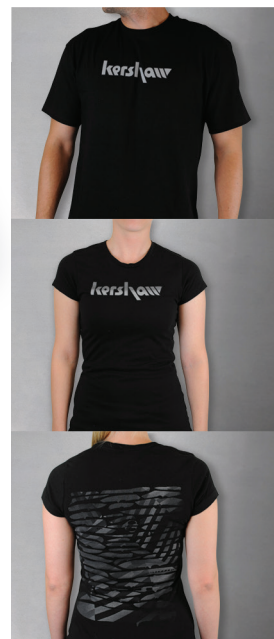

1019 KERSHAW HATS & BEANIE

HAT3

KERSHAW CAMO BASEBALL CAP

HAT4

KERSHAW, ORANGE BASEBALL CAP

HAT5

KERSHAW, PINK BASEBALL CAP

HAT6

KERSHAW, KNIT CAP BLACK

HAT7

KERSHAW, FLEXFIT HAT, BLACK S/M

HAT8

KERSHAW, FLEXFIT HAT, BLACK L/XL

HAT9

KERSHAW, FLEXFIT HAT, RED S/M

HAT10

KERSHAW, FLEXFIT HAT, RED L/XL

HAT 11

KERSHAW, FLEXFIT HAT, WHITE S/M

HAT 12

KERSHAW, FLEXFIT HAT, WHITE L/XL



Z997 KNIFE STORAGE BAG

MATERIAL NYLON SIDING WITH NYLON STRAPS

DIMENSIONS 13 IN. WIDE X 7-1/2 IN. HIGH

WEIGHT 12 OZ.

Double zipper case comes with 18 padded knife pockets and carry straps. Includes an 8-pocket removable center section. Ideal for carrying multiple knives



ADVANCED MATERIALS & INNOVATIVE TECHNOLOGY

Kershaw pioneered many of the materials and technologies now in common use throughout the knife industry. From high-performance blade steels, to handle materials like G-10 and titanium, to Diamond-Like Carbon (DLC) blade coatings, Kershaw has always been in the forefront. We not only think that keeps things interesting, but it also ensures that Kershaw Knives offer our customers both attention-getting looks and the highest level of performance.

When it comes to technology, Kershaw design engineers are always working on the Next Big Thing. While technologies that we introduced to the market—like SpeedSafe assisted opening—continue to be in demand, we're always at work on innovative, new technologies, too. Our patent-pending Composite Blade technology, which combines two steels in one blade, the KVT ball-bearing opening system, and our new K-Texture grip are just a few examples.

In the next few pages, we'll introduce you to the types of steel Kershaw is currently using, explain how we make our Composite Blades, and provide a rundown on our handle materials and blade coatings. You'll also find a glossary of common knife-industry terms and a new index that makes it easy to look up any Kershaw knife by its model number. (To look up our products by name and category, please check the Table of Contents in the front.)

COMMON ELEMENTS FOUND IN HIGH-QUALITY STEEL

1. Molybdenum
2. Cobalt
3. Iron
4. Carbon
5. Nickel
6. Chromium
7. Vanadium
8. Tungsten
9. Manganese
10. Silicon

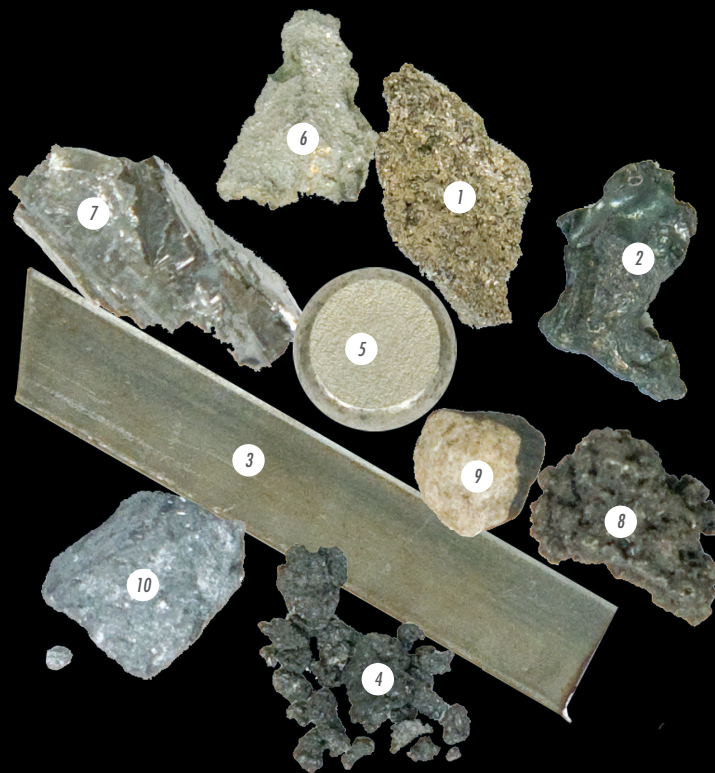

IT STARTS WITH THE STEEL

Steel is an alloy of iron and carbon. Most steel also has additional elements alloyed in it to enhance specific characteristics. For example, stainless steels contain chromium to enhance stain resistance. Nickel adds strength and toughness. Here's a quick guide to the various elements that can make up blade steel—as well as the properties specific elements enhance:

MOLYBDENUM

Improves hardenability, wear resistance, toughness, helps during tempering to ensure steel does not become brittle

COBALT

Improves strength and hardness at elevated temperatures

IRON

The element iron is the main “ingredient” in steel. Fortunately for knife users, iron is the most common element on the planet; it is alloyed with carbon to produce steel.

CARBON

Improves strength, hardness, wear resistance, and hardenability; can reduce ductility and toughness

NICKEL

Improves strength, toughness, corrosion resistance, and hardenability

CHROMIUM

Improves toughness, hardenability, wear and corrosion resistance; promotes hardness during heat treatment

VANADIUM

Improves strength, toughness, abrasion resistance at elevated temperatures; controls grain growth during heat treatment

TUNGSTEN

Improves hardness, strength, wear resistance, toughness, and stability at high temperatures

MANGANESE

Improves toughness in high-strength, low-alloy steels

NITROGEN

Improves strength and hardness; decreases toughness and ductility

PHOSPHORUS

Improves strength, hardenability, and corrosion resistance, but reduces toughness

SILICON

Improves strength, hardness, corrosion resistance, and electrical conductivity

SULPHUR

Improves machinability with manganese, lowers impact strength and ductility

KERSHAW BLADE STEELS

There's no such thing as one "best" type of steel for every type of knife. Instead, think in terms of the best steel for a particular application. Kershaw chooses its blade steels based on a variety of criteria, from ability to hold an edge and corrosion resistance to strength, toughness, and value. Then each type of steel is matched to the function of the knife, the design of the blade, and angle to which it will be sharpened—among other knifemaker's considerations. As steel technology continues to evolve, Kershaw will continue to select the very best of these steels to become Kershaw knife blades.

HERE IS AN INTRODUCTION TO SOME OF OUR HIGH-PERFORMANCE STEELS:

SANDVIK 14C28N

Developed in a Partnership Between Kershaw and Sandvik Steel

Kershaw worked with Sandvik Steel, one of the world's leading manufacturers of stainless steel and special alloys, to produce this high-performance steel. Increased nitrogen in the formula enables 14C28N to provide both excellent corrosion resistance and the ability to be hardened to 58-60 Rockwell. Sandvik calls 14C28N the overall highest performing knife steel in the world that still maintains the productivity benefit of being fine-blankable. (See the glossary for a definition.)

8CR13MOV

You may have heard that 8CR13MoV stainless is basically the equivalent of AUS8A. And it's true. For everyday use, even a serious "knife knut" would be hard-pressed to tell the difference between a well-made 8CR13MoV blade and a well-made AUS8A blade. Nevertheless, there are slight differences in the steel formula. While most other components are relatively equal, 8CR13MoV has slightly more carbon for hardness and wear resistance and slightly less nickel. The key to blade performance for both of these steels is manufacturing quality. That's where Kershaw's expertise comes in. Kershaw precision heat-treats 8CR13MoV steel to bring out its best high-performance characteristics: the ability to take and hold an edge, strength, and hardness. 8CR13MoV is top-of-the-line Chinese steel and, we believe, offers our customers an excellent value.

D2

"Semi-stainless" tool steel known for excellent wear resistance and good toughness

420

Very stain resistant and tough, but somewhat "softer;" Kershaw uses this steel in handle liners rather than blades

420MODIFIED

Highly stain and wear resistant, but more ductile; excellent for use where "flex" is desirable, for example, fish fillet knives

AUS6A

High-quality Japanese stainless steel; provides good wear resistance, toughness, and the ability to take an edge

AUS8A

With slightly more carbon than AUS6A, it offers strength, hardness, and wear resistance

CRUCIBLE CPM S30V

All-around premium knife steel that takes and holds an edge extremely well; also extremely tough and wear resistant

1.4116

A quality German steel that is highly stain resistant, tough, and corrosion resistant

65MN

A tough, durable steel for hard-use applications such as Kershaw's Camp Series machetes

STEEL CHART

STEEL	CARBON	CHROMIUM	COBALT	COPPER	MANGANESE	MOLYBDENUM	NICKEL	NITROGEN	PHOSPHORUS	SILICON	SULPHUR	TUNGSTEN	VANADIUM	HRC
D-2	1.40-1.60	11.00-13.00	-	-	0.60	0.70-1.20	0.30	-	-	0.60	-	-	1.10	57-61
420	0.15	12.00-14.00	-	-	1.00	-	-	-	0.04	1.00	0.03	-	-	52-56
420 MODIFIED	0.40-0.50	12.00-14.00	-	-	0.80	0.60	-	-	0.05	1.00	0.02	-	0.18	54-56
AUS6A	0.55-0.65	13.00-14.50	-	-	1.00	-	0.49	-	0.04	1.00	0.03	-	0.10-0.25	57-58
AUS8A	0.70-0.75	13.00-14.50	-	-	0.50	0.10-0.30	0.49	-	0.04	1.00	0.03	-	0.10-0.26	58-59
8CR13MOV	0.80	13.00	-	-	0.40	0.15	0.20	-	0.02	0.50	0.01	-	0.10	58-60
CPM S30V	1.45	14.00	-	-	-	2.00	-	0.20	-	-	-	-	4.00	57-59
14C28N	0.62	14.00	-	-	-	0.55	-	0.08	0.030	0.25	0.015	-	-	58-60
1.4116	0.50	14.50	-	-	1.00	0.65	-	-	-	1.00	-	-	0.15	55-57
65 Mn	0.57-0.70	-	-	-	0.60-0.90	-	-	-	0.040	-	0.050	-	-	52-55

COMPOSITE BLADE TECHNOLOGY GET TWO STEELS IN ONE BLADE



Kershaw's revolutionary Composite Blade technology enables us to design a blade with no compromises. We can use premium steel designed for wicked edge retention on the blade's cutting edge and steel designed for superior strength along the spine. And since the premium edge steels we're using tend to be rather expensive, making the entire blade from such "exotic" steels could make them cost prohibitive for many knife enthusiasts. Our patent-pending Composite Blade technology makes it affordable for most everyone to own a truly amazing knife.

To make a Composite Blade, Kershaw laser-cuts two interlocking blade components, one from each of the two types of steel that will eventually form the blade. The shapes can be simple or very complex. Then the two blade components are permanently joined through a metallurgical technique called brazing. The narrow copper line you see between the two blade components is the braze-welded joint. Is copper strong enough to permanently join steel to steel? In a word, yes. In fact, a braze-welded joint can be as strong or stronger than the metals it is joining. By annealing the blade to homogenize the grain structure and composition of the copper with that of the two steels being joined, Kershaw is able to produce extremely high-strength brazed joints in our Composite Blade knives.

KERSHAW HANDLE MATERIALS

Just as Kershaw matches the particular steel's characteristics to the end use and design of the knife, we also match the knife's handle material to its function and style. Many Kershaw handle scales are made of G-10 (see Glossary), which offers good looks, lightweight, and excellent strength. If we're trying to reduce a knife's weight, we might use aluminum handles. Sporting knives, which are often handled under wet conditions, might feature handles with our new K-Texture grip to make them extra secure.

Kershaw handle materials include: • G-10 • stainless steel • glass-filled nylon • titanium • carbon fiber • anodized aluminum • P.O.M. • steel with ABS inlay • anodized aluminum with Trac-Tec inserts • Micarta® • co-polymer • plastic

See glossary for more information on these handle materials.

KERSHAW BLADE COATINGS

If you've ever had a knife with a coated blade that looked cool when you first got it, but not so hot after just a year of use, you'll understand why Kershaw chooses the coating technologies it does. Because they last.

DLC COATING

Kershaw was one of the first to use DLC coating in production knife applications. DLC stands for Diamond-Like Carbon and, indeed, DLC coatings display properties similar to those of a natural diamond, notably hardness, wear resistance, and reduced friction. The benefits of such a coating are obvious when it comes to knives.

The DLC coating is applied in a process called Physical Vapor Disposition (PVD). During PVD, metals are instantly evaporated and ionized via a high-current, low-voltage arc. The metal ions are then accelerated into a vacuum chamber. A negative voltage is introduced, which permanently deposits a thin metal coating on the blades.

TITANIUM CARBO-NITRIDE

Kershaw also uses titanium carbo-nitride to produce an attractive black or grey blade coating that increases the blade's hardness, helps maintain the edge, and increases the overall lifetime of the blade.

TITANIUM OXIDE

When oxygen is introduced into the PVD process, the result is Kershaw's spectacular "rainbow" finishes. The Rainbow Chive, Scallion, and Leek all feature this amazing multicolored finish. And like our other PVD coatings, it won't scratch off.

ANODIZING

Anodizing is another process Kershaw uses to add durable color our products. Generally, we anodize aluminum handles to create lightweight handles that are still brilliantly colored. Some of our Leeks, our Blurs, are all examples of anodized aluminum finishes. Anodizing changes the microscopic texture of the surface so that a porous coating or film can be applied that will in turn accept a dye. Anodizing makes aluminum stronger and anodic films are much longer lasting than other surface colorations.

BLACK OXIDE

A chemical bath converts the surface of the steel to magnetite. Kershaw uses this coating on some blades and pocket clips, mainly for appearance, though it does add some corrosion resistance.

Glossary

Ability to take an edge Some steels take a sharper edge than others. Fine-grained steels take an edge more easily than coarse-grained ones.

ABS inlay Acrylonitrile butadiene styrene (ABS) is a common thermoplastic. It combines strength and rigidity with the toughness of rubber. Inlaid in steel handles, it also offers non-slip grip characteristics.

Alloy A mixture of two or more metals in solution; the atoms of one replace or occupy spaces between the atoms of the other so that the materials are inextricably joined.

Ambidextrous Able to use both left and right hands with equal ease. In relation to knives, it means that the knife is usable by both left and right-handers with equal ease.

Aluminum Kershaw uses 6061-T6 aerospace aluminum to create some of our knife handles. Aluminum combines high strength with workability, corrosion resistance, and good acceptance of coatings.

Anodized aluminum Anodizing changes the microscopic texture of the surface of the aluminum so that a porous coating or film can be applied that will accept a dye. Anodizing makes aluminum stronger and anodic films are much longer lasting than other surface colorations. Anodized aluminum knife handles are highly scratch resistant and fade resistant.

Belly The deeply convex-curved part of the blade, often found in skinning knives and multi-tasking knives.

Bolster The junction between the handle and the knife blade. A thick bolster can serve as a safety feature; it also contributes to knife balance.

Carbide A hard material made of compacted carbon and heavy metals used to make metal-cutting tools. Kershaw uses a carbide tip as a glass-breaker in some of our rescue tools.

Carbon fiber A strong, lightweight weave of bonded carbon atoms. Kershaw occasionally uses it in handle scales; a premium material.

Choil The start of the cutting edge. The choil is unsharpened and can be decoratively shaped.

Clip-point blade A blade shape in which the blade is clipped off at a straight or slightly curved concave angle to the point. Provides a thin, aggressive point, yet sheaths easily.

Computer Numerical Controlled (CNC) machining

Adds dimension to a knife blade or handle and enhances performance. CNC machines can be programmed to execute a precise series of machining operations that can result in the production of some of the complex components of a knife. Kershaw was one of the pioneers in mainstreaming the production of 3D-machined knives. We chose to use CNC machines because they give us the flexibility to create the complex part geometries that some of our knife designs require. CNC also gives us the ability to create just a few pieces for limited-run products or thousands of pieces for knives we produce in higher quantities.

Co-polymer A polymer is a large molecule composed of repeating structural units and can be either synthetic or natural. A co-polymer is a compound

of two or more different molecules, chosen for specific characteristics. The co-polymers Kershaw uses for knife handles generally have a slightly rubbery texture to improve grip security.

Corrosion resistance the ability of steel to resist deterioration through reaction with elements in its surrounding environment.

DLC Coating Diamond-Like Carbon coating; a coating that displays properties similar to those of natural diamond, including hardness, wear resistance, and reduced friction. Kershaw uses it to enhance the performance of knife blades and produce an attractive finish.

Drop forging a process by which a knife blade is made by forcing hot steel into a metal die.

Drop-point blade a very common blade style providing a strong, convenient point and easy sheathing; very common in hunting blades and work knives.

Edge retention the ability of a steel to resist abrasion and wear so that the edge stays sharper longer.

Ergonomics the design science of making products comfortable and efficient for human use.

Fine blanking manufacturing process that uses high-precision tools to fabricate a knife blade (or other part) to a shape very near to its final dimensions. Fine-blanked blades need little grinding or re-shaping.

Flipper A flipper enables you to open a knife with your index finger. Apply pressure to the flipper and the knife opens quickly and easily. Flippers may be found on both manual and SpeedSafe® knives.

Full tang knife A knife which is built of one solid piece of blade steel from tip to butt; scales are usually attached to form the handle.

G-10 An epoxy-filled woven glass fiber; it is extremely stable, unaffected by temperature changes, and can be decoratively tinted, ground, and polished. G-10 makes excellent handles and handle scales for knives.

Glass-filled nylon Nylon synthetic polymer is reinforced with glass threads for increased strength, stiffness, and dimensional stability combined with excellent wear resistance.

Hardenability The ability of a steel to be hardened by heat treatment.

Hardness Like strength, hardness is a measure of resistance to deformation. The Rockwell Hardness Scale numbers that you often see in our specs refer to the relative hardness of metals determined by the depth of penetration into the metal by a steel ball or diamond cone.

Heat treatment A controlled heating and cooling process designed to improve the physical properties and characteristics of the steel. Tempering, annealing, and quenching are all forms of heat treatment.

Impact resistance The ability of a material to resist cracking or breaking due to sudden impact.

Inclusions Non-metallic particles that can either form naturally during the steel-making process or can accidentally get into steel. These inclusions can affect the steel's quality; the fewer the inclusions, the cleaner and higher quality the steel.

Inset liner lock To build an inset liner lock, Kershaw insets a strip of steel inside a knife's handle, usually when the handle is G-10 or glass-filled nylon. Insetting the lock in this way enables us to create a slimmer knife, while still providing the strength and security of a locking liner.

Jimpping Notches on the spine of a knife blade (or other places on a knife) designed to help prevent your hand from slipping during use.

K-Texture®

An exclusive, rubberized texture and pattern used on the handle of certain Kershaw knives. K-Texture which provides an extremely secure grip.

Lanyard hole A hole in the butt end of the knife to enable to user to attach a cord or lanyard.

Left/right-hand carry pocketclip The knife handles on some models are drilled for both left and right hand clip carry allowing the clip to be mounted on either side of the handle and thus ideal for both left- and right-handed knife users.

Lock back A pivoted latch connected to a spring and positioned on the back of a knife handle. It locks the blade open. To close the knife, depress the latch to release the blade.

Locking liner On a folding knife, the liners are the flat plates that support the handle sides, bolsters, spine, and blade pivot. In a locking liner, as the blade is opened, one of the liners moves behind the blade to hold it in the open position. This prevents the knife from accidentally closing. To close the knife, the locking liner must be pushed to the side and the blade folded back into the handle.

Micarta® An industrial laminate composed of layers of fiber embedded in a resin and subjected to heat and high-pressure to make the material extremely hard and dense; has industrial and decorative applications.

PMMA Plastic Polymethyl methacrylate is strong and lightweight material, familiar to most people as acrylic glass. It has good impact strength and is highly versatile.

POM Polyoxymethylene-Delrin® (POM) is a rigid, high-strength engineering plastic. It is often used in food applications as it offers extremely low moisture absorption, high-impact resistance, and is very easy to clean.

Recurve blade A blade with a concave curve off the choil that flows into a deep belly. A recurve blade is built for multi-tasking, offering minimal mass, and maximum performance. It provides leverage for tough cutting tasks and a precisely centered point for piercing.

Rockwell Hardness Scale A measurement of the hardness of a material based on the depth of penetration of a diamond cone pressed into the material at a constant pressure.

Safety Tip-Lock A small slider that locks the tip of the blade in the handle until the user releases it. It is available on a number of our SpeedSafe® models.

Scales The pieces of material that are fitted to the tang of a full-tang knife or to the liners of a folding knife. There are a wide variety of handle materials available from natural, such as wood and bone, to manmade, such as G-10.

Sheepsfoot/Warnecliffe blade A blade with a fairly straight cutting edge with the spine rounded down to meet the point. It is a very strong design for bearing down on a cutting chore.

Spearpoint blade A blade that is sharpened on both top and bottom, generally used as weapons.

SpeedSafe® Kershaw's patented manual assisted-opening system; the user starts the blade out of the handle, then the SpeedSafe® torsion bar takes over to fully open the knife.

Stain resistance The "stainless" in stainless steel; this is its ability to withstand rust.

Strength is the ability to take a load without permanently deforming. When it comes to steel, strength is directly related to hardness. The harder the steel, the stronger it is.

Sub-Frame Lock Kershaw uses the Sub-Frame Lock to create an extremely sturdy locking frame in our lightweight anodized aluminum or G-10 handles. This enables us to make a larger knife that is still light enough to carry every day. One side of the handle is fitted with an inset plate of stainless steel. The stainless-steel plate is integral to the frame and is the part of the frame that moves into place behind the blade to secure it. Release the Sub-Frame Lock just as you would any other frame lock.

Tanto/modified tanto blade a blade with two edges, the bottom cutting edge and a shorter edge angled from the point. Good for punching and multi-purpose use. Knifemakers modify the tanto blade in numerous ways for both style and function.

Tempering slow, steady heating of steel, followed by a slow cooling phase; this heating and cooling helps relieve stress in the steel to strengthen it.

Tensile strength the ability of steel to resist breakage by stretching.

Tip-up/Tip-down carry this refers to the position in which a folding pocketknife is carried when clipped to the pocket: with the closed tip pointing up or down. Many Kershaw knives offer the ability to reverse the clip for either method of carry.

Titanium a lightweight, corrosion-resistant metal with high tensile strength. Often used as handle materials, for liners, or as a blade coating, where it enhances performance.

Toughness the ability of the steel to withstand shock loading without damage; the opposite of brittleness. In a blade, higher toughness means less chipping or cracking. Toughness can be lost in very hard steel, although heat treatment can be used to improve toughness in a hard steel.

Trac-Tec A rough-surfaced insert that provides additional friction for a non-slip grip.

Wear resistance the ability of the steel to withstand abrasion.

BLADE INDEX

1006K Amphibian 46	1288SH 8-1/2 in. Spoon-Handle Fillet 42
1008 Sea Hunter 46	1289 9 In. Narrow Fillet 42
1008BL-P Sea Hunter (Blunt-Tip) 46	1290 Spear-Point Bait Knife 14
1010 Roughneck 39	1291 5-1/2 IN. Boning Knife 14
1018 Camp Ax 45	1292 5-1/2 IN. Gutting/Scaling Knife 14
1019 Firestarter 51	1445 Half-Ton 17
1028 Antelope Hunter II 38	1446 3/4-Ton 17
1028OR Antelope Hunter II (Orange) 38	1447 One-Ton 17
1029 Bear Hunter II 38	1550/ST Blackout 25
1045 Black Colt II 19	1555TI Cryo 31
1050 Folding Field 40	1556TI Cryo II 6
1060 Black Horse II 19	1560/ST Whirlwind 25
1060RT Camo Black Horse II 39	1600 Chive 27
1074 Camp 18 13	1600BL Chive (Black) 27
1076 Camp 14 13	1600PINK Chive (Pink) 27
1077 Camp 10 13	1600VIB Rainbow Chive 28
1080 Skinning Knife 37	1605/ST Clash 34
1080OR Skinning Knife (Orange) 37	1605CKTST Black Clash 34
1081 Mini Skinner 37	1620/ST Scallion 25
1082 Field Knife 37	1620C Camo Scallion 39
1082OR Field Knife (Orange) 37	1620FL/ST Scallion FL 26
1085 Diskin Hunter 38	1620NB Scallion (Navy Blue) 8
1091CT Camp-Tool Blade Trader 44	1620OL Scallion (Olive Drab) 8
1094HBT Hunter's Blade Trader 43	1620PUR Scallion (Purple) 8
1095SBT Sportsman's Blade Trader 43	1620RD Scallion (Red) 26
1096FBT Fisherman's Blade Trader 44	1620VIB Rainbow Scallion 26
1098AK Alaskan Blade Trader 43	1660/ST Leek 29
1099DBT Deluxe Blade Trader 44	1660CB Composite Blade Leek 30
1120 Taskmaster Shears 40	1660CKT/ST Leek (Black) 29
1210 Skeeter I 41	1660GRYST Random Leek 30
1215 Skeeter II 41	1660OL Leek (Olive Drab) 10
1256 Folding Fillet 41	1660OR Leek (Orange) 10
1257 7-1/2 IN. Fillet 41	1660PUR Leek (Purple) 10
1259 9 IN. Fillet 41	1660SWBLK Leek (Stonewashed, Black) 9
1280 10 In. Curved Breaking 42	1660VIB Rainbow Leek 29
1280GE 10 in. Breaking Knife, Granton Edge 42	1670BLK/ST Blur (Black) 23
1282 12 in. Cimeter 42	1670DS Blur (Desert Sand) 23
1287 7-1/2 in. Narrow Fillet 42	1670GBBLKST Blur GlassBreaker 24
1288BK 8 in. Breaking 42	1670OL Blur (Olive Drab) 23
	1670RDBLKST Blur 9

BLADE INDEX (CONT.)

1670S30V S30V Blur	24
1670TLKST Tanto Blur	24
1725CB Junkyard Dog II	16
1730SS Zing SS	28
1760 Skyline	16
1770 OD-2	16
1780CB Rake	22
1820 Needs Work	30
1830 Oso Sweet	31
1835BLKST Kuro	31
1840/ST Shallot	28
1840CKT/ST Black Shallot	28
1860 Piston	23
1870 Knockout	22
1880 Echelon	22
1895 LoneRock Sm Fixed	12
1894 LoneRock ZipIt Pro	12
1896GH LoneRock Lg Fixed, Gut Hook	12
1898 LoneRock Folder	11
1898GH LoneRock Folder, Gut Hook	11
1920 Select Fire	18
1970/ST Burst	32
1980ST RJ II	32
1985ST RJ I	32
1990 Brawler	34
2520 Zipit	40
2520OR Zipit (Orange)	40
2535 Ultra-Tek Sharpener	51
2555 TaskMaster Saw	9
2800 Silver Spur I	20
2825 Silver Spur II	20
3000 D.W.O.	20
3000RD D.W.O. (Red)	20
3100 Grant County	20
3115 Corral Creek	20
3115BT Corral Creek Sheepfoot	20
3120 Black Gulch	20
3140 Wildcat Ridge	20
3160 Crown	19
3200 Ripcord	45
3410 Chill	18
3650/ST Volt II	33
3650CKTST Black Volt II	33
3655 Volt SS	33
3700 Kurai	18
3880 Thermite	6
3810 Dimension	7
3820 Injection 3.0	5
3830 Injection 3.5	5
3840 FreeFall	7
3850 Swerve	7
3890 Scrambler	5
4351 Military Knife	45
8000OL Funxion Outdoor	35
8100GRYST Funxion EMT	35
8200RD Funxion DIY	35
8700 Shuffle	6
9900 Paring	48
9900-7 Block Set	49
9910 Vegetable	48
9915 Paring	48
9920 Boning	48
9921 Utility	48
9922 Steak	48
9922-7 Steak Knife Set	49
9940 Chef's	48
9945 Chef's	48
9950 Santoku	48
9960 Bread	48
9970 Slicing	48
9990 Honing Steel	48
CB-3 Cutting Board Set	49
Kershaw Hats	52
Kershaw T-Shirts	52
T TOOL KeyChain T-Tool	51
Z997 Knife Storage Bag	52

Kershaw Knives • Kai USA Ltd

LIMITED LIFETIME WARRANTY

Kershaw Knives carry a limited warranty for the lifetime of the original owner, except when stated otherwise. Our products are guaranteed to be free from defects in original material and construction and to perform as advertised when properly used and maintained. Under this warranty, Kai USA Ltd. will repair or replace any product we find to be defective in its original material or construction. This Limited Lifetime Warranty is non-transferable and does not cover normal signs of wear, rust, or damage/breakage due to improper use or maintenance. To receive warranty repair or replacement, the owner must send the product to be evaluated by Kai USA Warranty Services in our Tualatin, Oregon headquarters. In addition to the provisions of this warranty, you may also have other rights that can vary by state. No other warranties are implied or expressed other than what is specifically stated here.

LIABILITY DISCLAIMER

Kershaw Knives are intended and sold for legitimate sporting and/or culinary purposes only. The purchase, use, and ownership of knives are subject to a wide variety of local laws and regulations. Due to the complexity and constantly changing nature of these laws and regulations, it is the responsibility of the buyer to investigate and comply with the laws and regulations that apply in his or her specific area. You, and not Kai USA Ltd., are solely responsible for any claims resulting from violation of these laws and/or regulations. Any use of these products other than cutting is considered misuse and abuse and Kai USA Ltd. is not responsible for any injuries or damages caused by misuse and/or abuse.

WARNING! Knives are extremely sharp tools and should only be used or handled with the utmost care and caution. Any use other than cutting is considered misuse and abuse — and will void your warranty. Kai USA is not responsible for injuries resulting from misuse or abuse of the product.

KershawKnives.com

 Facebook.com/KershawKnives

 @KershawKnives

 @KershawKnives

 KershawOutdoor.tumblr.com

KAI U.S.A. LTD.

18600 SW Teton Ave Tualatin, OR 97062
Toll-Free (800) 325-2891

503-682-1966 • Fax 503-682-7168

LITCAT2013 REV. B • Printed in the USA

